

14.4kW 208V 3PH Switched PDU - LX Interface, Gigabit, 18 Outlets, Hubbell 50A CS8365C Input, Outlet Monitoring, LCD, 1.8 m Cord, 0U 1.8 m Height, TAA

MODEL NUMBER: PDU3EVSR6H50A

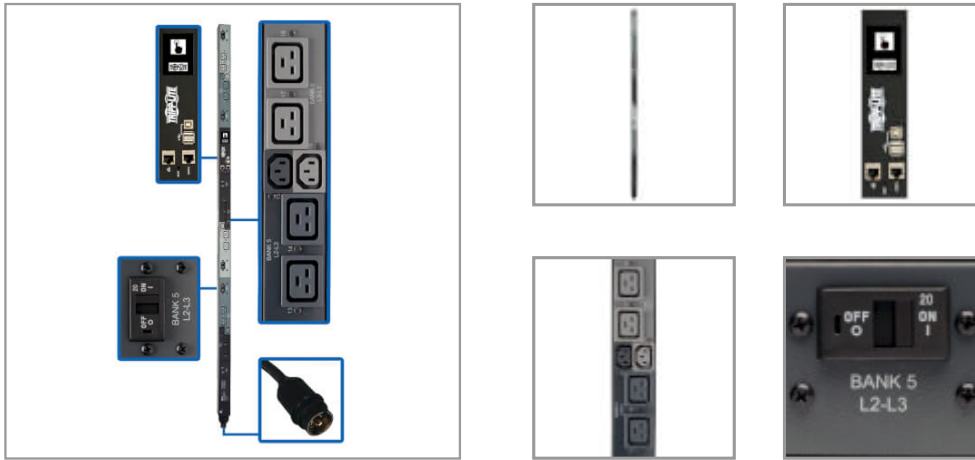

3-phase switched PDU distributes, monitors and manages power in a medium/large data center or network installation.

Features

3-Phase PDU Distributes, Monitors and Manages Network-Grade Power Recommended for data centers, server rooms and high-density network closets, this switched PDU provides advanced network control and remote power monitoring with the ability to turn on, turn off, reboot or lock out power to each outlet. You can more efficiently manage network power consumption and remotely reboot locked network items without having to visit the site. Reducing the number of on-site visits can help lower the cost of data center maintenance, thus lowering the 0U PDU's total cost of ownership.

18 Outlets Dispense AC Power to Connected Equipment During normal operation, 18 individually controllable outlets—six C13 and 12 C19—in six separately breakered load banks distribute AC power to rack equipment. Each 208V outlet is accompanied by an LED that illuminates when the outlet is ramped up and ready to be used. The outlets and banks can be individually monitored to ensure proper load balance and prevent downtime. Plug-lock insert sleeves are included to prevent connected cables from becoming accidentally dislodged.

Built-In GbE-Capable Network Management Card Allows Remote Access 24/7 The built-in WEBCARDLX with the latest version of PowerAlert Device Manager firmware (PADM20) provides enhanced remote management capabilities, including customizable dashboard graphs to fit user preferences. The PADM20 upgrade and Tripp Lite's PowerAlert Element Manager (PAEM) software form a powerful tool for expanding maintenance functions in large installations, including firmware update checks and backup and restoration of device configurations. PADM20's Auto Probe feature allows a PDU with switched loads to automatically reboot devices if a network communication failure is detected. This preserves uptime and minimizes the time and expense associated with on-site support.

Color Touchscreen LCD Offers Important Data at a Glance An easy-to-navigate color touchscreen LCD reports network data, input current level per phase, and output current per load bank and per outlet with $\pm 1\%$ billing-grade accuracy. It also generates a unique QR code to allow read-only access to the 3-phase PDU via mobile device. If an EnviroSense2 module is connected to the PDU, the LCD also displays its status and environmental data, such as temperature and humidity.

Highlights

- 6 C13 and 12 C19 208V outlets distribute AC power to connected equipment
- Pre-installed GbE-capable WEBCARDLX with latest version of PADM20 for IP-based Auto Probe feature
- Remote power monitoring and control reduces on-site visits and maintenance costs
- 1.8 m power cord with Hubbell 50A CS8365C (3P+E) 3-phase input connects to AC power source
- Color touchscreen LCD provides current levels, environmental data and network info

Applications

- Power mission-critical rack equipment in a data center, computer room or high-density network closet
- Monitor power loads from various computers, switches, servers and other networking equipment
- Maintain a computer network in a government, commercial or industrial facility
- Manage multiple rack devices by rebooting or shutting down individual outlets as needed

Package Includes

- PDU3EVSR6H50A 14.4kW 3-Phase Switched PDU
- Built-in LX Platform interface
- Configuration cable
- (18) Plug-lock insert sleeves
- Rack-mounting hardware
- Spare mounting buttons
- PDUMVROTATEBRKT mounting bracket accessory
- Owner's manual



Tripp Lite
1111 W. 35th Street
Chicago, IL 60609 USA
Telephone: 773.869.1234
www.tripplite.com

Easy to Install Vertically in an EIA-Standard 19 in. RackThe 70-inch 0U PDU mounts vertically using the pre-installed toolless mounting buttons or the included brackets. Spare buttons are also included. Use the included PDUMVROTATEBRKT kit to install the Hubbell PDU with outlets facing the rear for better airflow or equipment access. A 6-ft. (1.83 m) cord with Hubbell 50A CS8365C (3P+E) 3-phase input connects the switched PDU to a compatible AC power source, generator or protected UPS.

TAA-Compliant for GSA Schedule PurchasesThe PDU3EVSR6H50A is compliant with the Federal Trade Agreements Act (TAA), which makes it eligible for GSA (General Services Administration) Schedule and other federal procurement contracts.

2-Year WarrantyThe PDU3EVSR6H50A is backed by a 2-year warranty, ensuring reliability and performance.

Specifications

OVERVIEW	
UPC Code	037332206763
PDU Type	Switched
INPUT	
PDU Input Voltage	208
Recommended Electrical Service	Three-phase 50A 208V service
Maximum Input Amps	40
Maximum Input Amps Details	Agency de-rated to 40A continuous
PDU Plug Type	HUBBELL CS8365C 50A
Input Phase	3-Phase
Input Cord Details	6GA (SOOW)
Input Cord Length (ft.)	6
Input Cord Length (m)	1.83
OUTPUT	
Output Capacity Details	14.4kW (208V) total capacity; 20A max per breakered outlet bank; 16A max per C19 outlet; 12A max per C13 outlet
Frequency Compatibility	50 / 60 Hz
Output Receptacles	(6) C13; (12) C19
Output Nominal Voltage	208V
Overload Protection	6 20A circuit breakers, 1 per outlet bank
Customized Load Management Receptacles	Each outlet is individually controllable via remote interface
USER INTERFACE, ALERTS & CONTROLS	
Reported Load Segments	Supports monitoring of current per input phase (L1, L2, L3), output current per load bank (Banks 1-6) and per output receptacle (1-18); Outlets are color-coded and labeled for phase and load bank identification; L1-L2 powers black outlets (Banks 1&4); L2-L3 powers dark-gray outlets (Banks 2&5); L3-L1 powers light-gray outlets (Banks 3&6)



Tripp Lite
1111 W. 35th Street
Chicago, IL 60609 USA
Telephone: 773.869.1234
www.tripplite.com

Front Panel LCD Display	Touchscreen LCD reports NETWORK DATA (IP address, Subnet Mask, Gateway, MAC Address, Device Name, Model, Serial Number), INPUT PHASE DATA (Amperage, Wattage, Voltage per phase, plus Unbalance percentage), LOAD BANK DATA (Amperage, Wattage, Voltage per load bank, plus total PDU output in watts), CONFIGURATION DATA (Listing of current configuration settings), ENVIRONMENTAL DATA (Reports data and status of E2 sensor modules; Sensor options are available for temperature and humidity, plus input and output dry contacts), MOBILE ACCESS (Generates a unique QR code to view reported PDU details on a mobile device)
Front Panel LEDs	One LED for each output receptacle offers power availability information: GREEN (Power ON), YELLOW (Warning condition), RED (Critical condition). Network Activity (Green): Flashes for network activity. Link/Network Speed (Yellow): On steady for any speed.
Switches	LX Platform Interface: Recessed reset switch for interface reboot and factory reset
Current Measurement Accuracy (Amps)	+/-1%
Voltage Measurement Accuracy (Volts)	+/-1%
Power Measurement Accuracy (Watts)	+/-1%
SURGE / NOISE SUPPRESSION	
Automatic Shut-Off	No
PHYSICAL	
Material of Construction	Metal
Form Factors Supported	Vertical rackmount installation supported with included mounting brackets; supports toolless mounting in button-mount compatible racks
PDU Form Factor	Vertical (0U)
Shipping Dimensions (hwd / in.)	7.09 x 9.65 x 75.87
Shipping Weight (kg)	12.51
Unit Dimension Details	Chassis dimensions shown; See submittal drawing for further detail
Unit Dimensions (hwd / in.)	70 x 2.17 x 2.12
Unit Dimensions (hwd / cm)	177.8 x 5.5 x 5.406
Unit Weight (lbs.)	20.57
Unit Weight (kg)	9.33
ENVIRONMENTAL	
Operating Temperature Range	0C ~ 40C (32F ~ 104F)
Storage Temperature Range	-30°C to +50°C (-22°F to +122°F)
Relative Humidity	5-95% non condensing
Operating Elevation (ft.)	0-10,000
Operating Elevation (m)	0-3000
COMMUNICATIONS	
PowerAlert Software	LX Platform Interface: PowerAlert Device Manager
Communications Cable	USB B-to-USB A Configuration/Console Access cable



Tripp Lite
1111 W. 35th Street
Chicago, IL 60609 USA
Telephone: 773.869.1234
www.tripplite.com

Network Monitoring Port	RJ45 Network port, RJ45 Config/Console Access port; 2x USB A ports supports a variety of EnviroSense2 environmental and control modules. See Accessories>Management Hardware section for more information about these modules. USB B port (Configuration & Console Access)
SNMP Compatibility	SNMP V1, V2c, V3
Network Compatibility	10 Mbps; 100 Mbps (Fast Ethernet); 1 Gbps (Gigabit)
Communications Interface	Pre-installed network card; RS-232; USB
FEATURES & SPECIFICATIONS	
High Availability PDU Features	Auto Probe Monitoring and Reboot (included); Auto Load Shedding
STANDARDS & COMPLIANCE	
Product Certifications	CAN/CSA-C22.2 No. 60950-1 (Canada); NOM (Mexico); UL 60950-1
Product Compliance	RoHS; FCC Part 15 Class A (USA)
WARRANTY	
Product Warranty Period (Worldwide)	2-year limited warranty

© 2022 Tripp Lite. All rights reserved. All product and company names are trademarks or registered trademarks of their respective holders. Use of them does not imply any affiliation with or endorsement by them. Tripp Lite has a policy of continuous improvement. Specifications are subject to change without notice. Tripp Lite uses primary and third-party agencies to test its products for compliance with standards. See a list of Tripp Lite's testing agencies: <https://www.tripplite.com/products/product-certification-agencies>