

		BUY KIT 816038	
9	1	10	891109 D-RING, 1/4 OD x 1/8 ID x 1/16 THK
7	1	1	891040 POWER BIT, 3mm HEX, 1/4" [6.35] HEX SHANK
6	1	3	891039 BUSHING, .327 OD x .166 ID x 1/4" [6.35]
5	1	9	890871 SCREW, M4x 10mm, SOCKET HEAD CAP 3mm FEMALE HEX
4	4	12	891037 BELLEVILLE, DISC SPRING, 4.2mm ID x 8mm OD
3	2	6	891038 WASHER, METRIC, M4, THICK
ITEM QTY REQ'D	MULTI PAK QTY	PART NO.	DESCRIPTION

**RUNDOWN FIXTURE 251 ASSEMBLY
(816317 IF BOUGHT AS AN ASSEMBLY)**

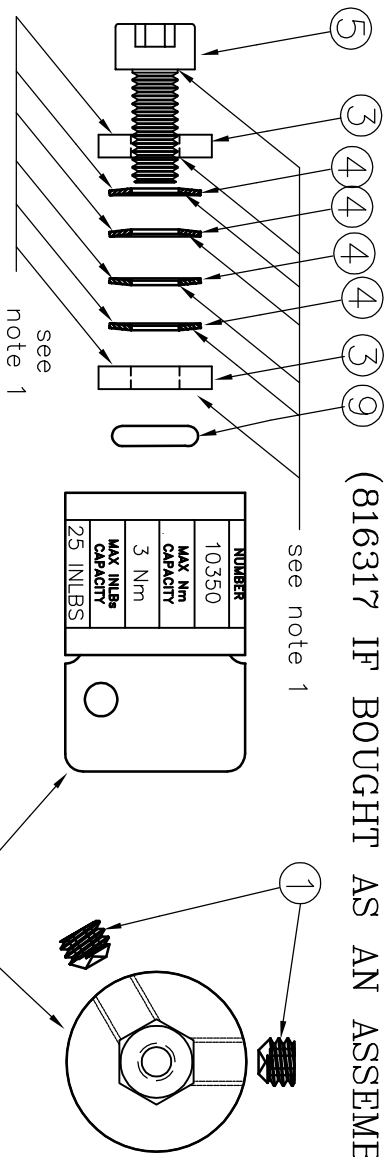

**NOTE 1:
ALL ENGAGING SURFACES MUST HAVE LUBRICANT
APPLIED TO THEM (SEE ITEM 8)**

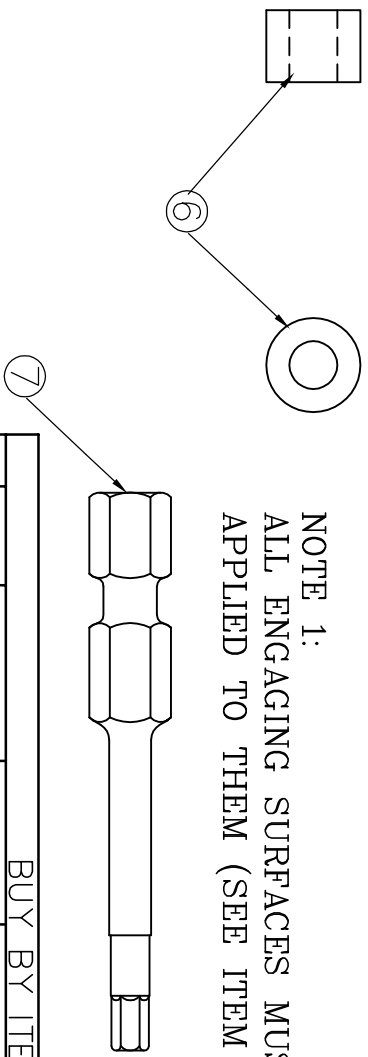

		BUY BY ITEM	
8	1	1	816034 MULTI PAK, MOLY GREASE, 1 POUND CAN
2	1	N/A	816317 MULTI PAK, WELDMENT, RUNDOWN 3 Nm FIXTUREW/ 1/4" FEMALE HEX
1	2	10	816840 MULTI PAK, SCREW SET HEX CUP PT 8-32x1/8 (INCLUDES BAG 820095 & LABEL 857000)
ITEM QTY REQ'D	MULTI PAK QTY	PART NO.	DESCRIPTION

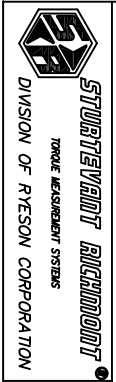

THIS PRINT AND ALL INFORMATION APPEARING THEREON IS THE PROPERTY OF "STURTEVANT/RICHMONT". NEITHER THE PRINT NOR THE INFORMATION OR DIVULGED TO ANY OTHER PERSON UNLESS SPECIFICALLY AUTHORIZED BY "STURTEVANT/RICHMONT".

PART DESCRIPTION
RUNDOWN FIXTURE 251
(3Nm), 1/4 FEMALE HEX

DIAGRAM NO. & REV.
10350-E