

THIS COPY IS PROVIDED ON A RESTRICTED BASIS AND IS NOT TO BE USED IN ANY WAY DETRIMENTAL TO THE INTERESTS OF PANDUIT CORP.

PANDUIT P/N	WEIGHT
P36E33M-XXYZ	SEE SHEET 2

SPECIFICATION:

1. STANDARD:
 UNIT TYPE: MONITORED SWITCHED
 ORIENTATION: VERTICAL, 0U FULL
 OUTLET QTY & TYPE: (30)C13, (6)C19
 INPUT VOLTAGE: 200-240VAC
 INPUT CURRENT: 30A (24A DERATED)
 BREAKER QTY & TYPE: (2) 20AMP, DOUBLE-POLE
 INPUT PHASE: SINGLE-PHASE
 RATED POWER: 5.0 kVA
 INPUT PLUG: NEMA L6-30P
 INPUT POWER CORD: SEE SHEET 2 FOR PART NUMBER TABLE
 REGULATORY STANDARD: RoHS COMPLIANT

2. ADDITIONAL:
 NONE
3. ACCESSORIES:
 (1) QUICK-START GUIDE

NOTES:

1. PRIMARY DIMENSIONS ARE IN MILLIMETERS. SECONDARY DIMENSION ARE IN [INCHES] .
2. INSTALLATION SHALL COMPLY WITH ALL APPLICABLE NATIONAL, STATE, AND LOCAL CODES .
3. VISIT OUR ON-LINE CATALOG AT WWW.PANDUIT.COM FOR A CURRENT LIST OF PRODUCTS APPLICABLE FOR USE WITH THIS PART .
4. FOR FULL PRODUCT FUNCTIONALITY REFER TO USER MANUAL .
5. DRAWING VIEWS SHOW THE INPUT CORD IN THE "TOP END FED" CONFIGURATION

IDENTIFICATION

FOR FINISHED GOOD PART NUMBER & DESCRIPTION TABLE SEE SHEET 2 CONFIGURABLE PART NUMBERS: P36E33M-XX Y Z

XX: FINISHED GOOD COLOR BL =BLACK YL =YELLOW RD =RED BU =BLUE WH =WHITE GN =GREEN	Y: INPUT FEED TYPE 1 =TOP-END FED 2 =BOTTOM-END FED	Z: INPUT CORD LENGTH A =1 METER B =2 METER C =3 METER
--	---	--

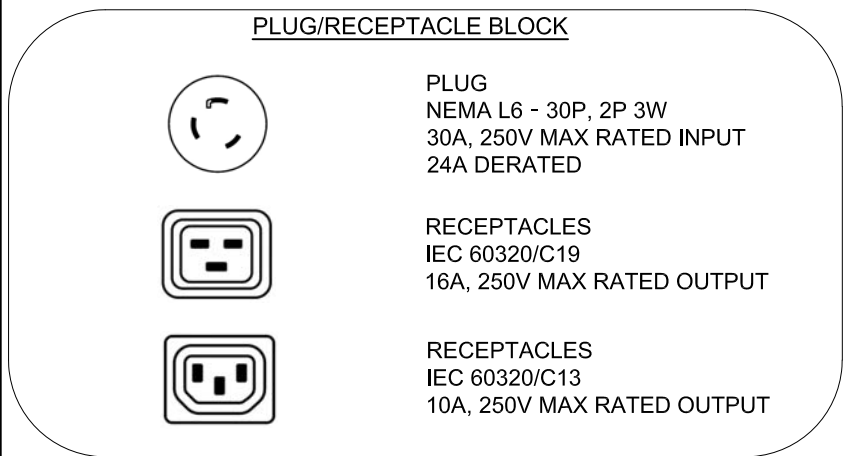
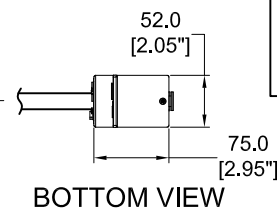
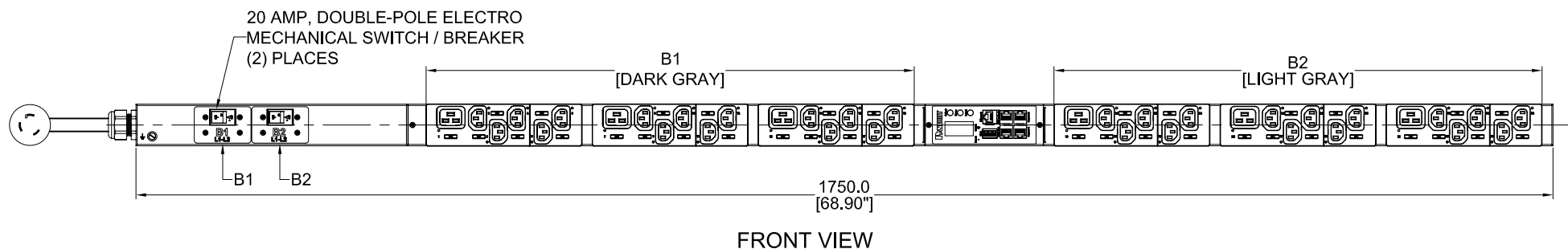
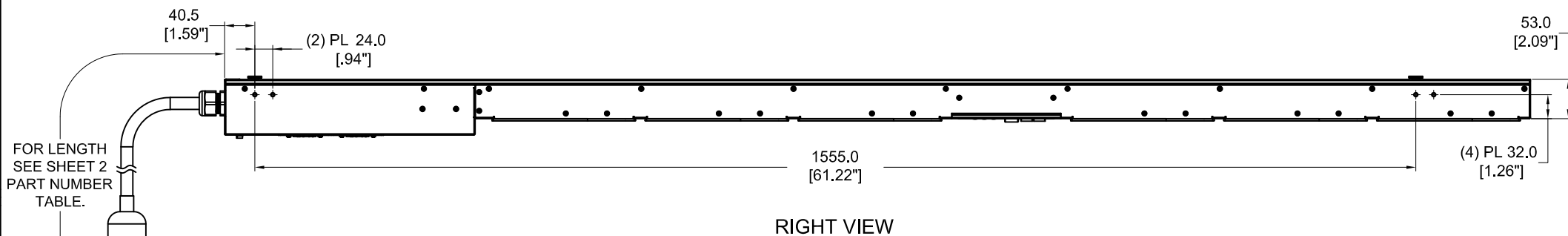
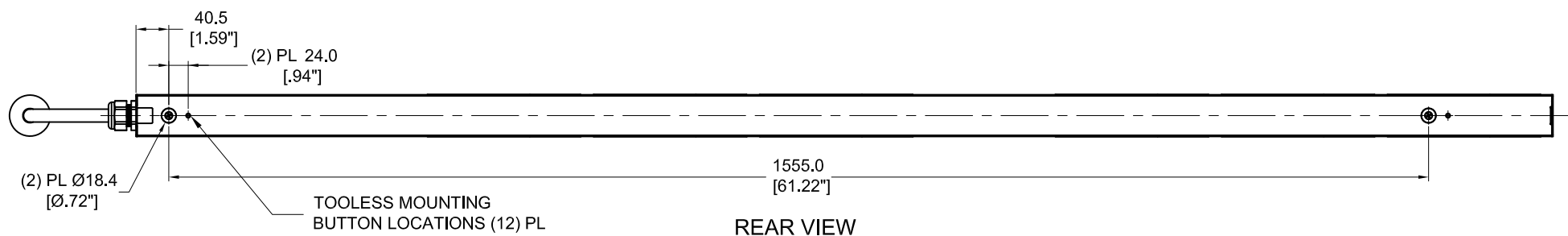
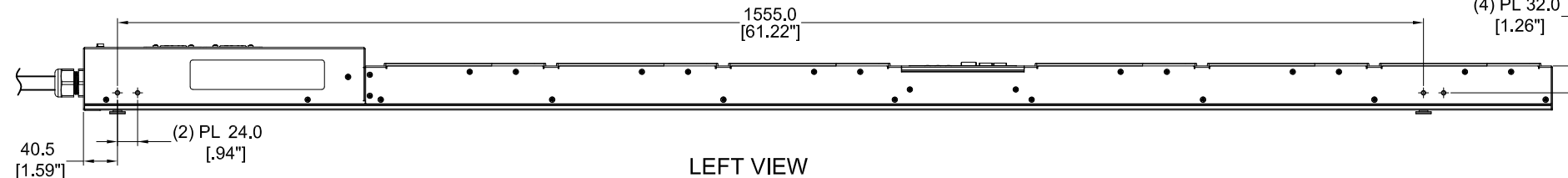

REV	DATE	BY	CHK	APR	DESCRIPTION	ECN
02A	06/07/2018	JF.YU	MIM	JAWI	ADDED SHEET 2 WITH CONFIGURABLE PART NUMBER TABLE AND DESCRIPTION UPDATED IDENTIFICATION TO INCLUDE CONFIGURABLE OPTION DE-CODER UPDATED CIRCUIT BREAKER LABELS WITH ROTATED TEXT	P36E33M
01A	10/18/2017	WSJ	MIM	EDM	INITIAL RELEASE	P36E33M

WE ASK THAT YOU CHECK FULLY THE DIMENSIONS, NOTES, AND SIGN THE CLIENT SIGNATURE BOX. THE JOB WILL NOT PROGRESS WITHOUT SIGNED APPROVAL. PLEASE DO NOT DELAY IN RETURNING PROOF AS IT WILL AFFECT DELIVERY		SIGN
		DATE
		PRINT
TITLE INTELLIGENT SERIES PDU P36E33M-XXYZ CUSTOMER DRAWING		
ITEM REVISION NAME		PANDUIT
DATASHEET FILE NAME:		
UNLESS OTHERWISE SPECIFIED DIMENSIONAL TOLERANCE ARE: mm [IN]		MATERIAL/COLOR: N/A
Tolerance(mm) 0<L<50 ±0.5 50<L<250 ±1.0 250<L<500 ±1.5 500<L<1000 ±2.5 1000<L<2000 ±4.0		DRAWING NUMBER: P36E33M_DC
DRAWN BY WSJ	DATE 10/18/2017	SCALE NONE
CHK SEAN	SHT 1 OF 2	
		SCALE B



THIS COPY IS PROVIDED ON A RESTRICTED BASIS AND IS NOT TO BE USED IN ANY WAY DETRIMENTAL TO THE INTERESTS OF PANDUIT CORP.

FINISHED GOOD PART NUMBER	FINISHED GOOD DESCRIPTION	COLOR	INPUT CORD LENGTH	WEIGHT
P36E33M	VERTICAL,(30) C13,(6) C19,MONITORED SWITCHED,200-240V/30A/1 PHASE , TOP-END FED, 3 METER INPUT CORD, BLACK	BLACK (RAL 9005)	3M(+254MM-127MM) 10'[+10"/-5"]	9.2kg
P36E33M-BL1A	VERTICAL,(30) C13,(6) C19,MONITORED SWITCHED,200-240V/30A/1 PHASE , TOP-END FED, 1 METER INPUT CORD, BLACK	BLACK (RAL 9005)	1M(+178MM-89MM) 3.3'[+7"/-3.5"]	8.4kg
P36E33M-BL1B	VERTICAL,(30) C13,(6) C19,MONITORED SWITCHED,200-240V/30A/1 PHASE , TOP-END FED, 2 METER INPUT CORD, BLACK	BLACK (RAL 9005)	2M(+178MM-89MM) 6.5'[+7"/-3.5"]	8.8kg
P36E33M-RD1A	VERTICAL,(30) C13,(6) C19,MONITORED SWITCHED,200-240V/30A/1 PHASE , TOP-END FED, 1 METER INPUT CORD, RED	RED (RAL 3020)	1M(+178MM-89MM) 3.3'[+7"/-3.5"]	8.4kg
P36E33M-RD1B	VERTICAL,(30) C13,(6) C19,MONITORED SWITCHED,200-240V/30A/1 PHASE , TOP-END FED, 2 METER INPUT CORD, RED	RED (RAL 3020)	2M(+178MM-89MM) 6.5'[+7"/-3.5"]	8.8kg
P36E33M-RD1C	VERTICAL,(30) C13,(6) C19,MONITORED SWITCHED,200-240V/30A/1 PHASE , TOP-END FED, 3 METER INPUT CORD, RED	RED (RAL 3020)	3M(+254MM-127MM) 10'[+10"/-5"]	9.2kg
P36E33M-WH1A	VERTICAL,(30) C13,(6) C19,MONITORED SWITCHED,200-240V/30A/1 PHASE , TOP-END FED, 1 METER INPUT CORD, WHITE	WHITE (RAL 9003)	1M(+178MM-89MM) 3.3'[+7"/-3.5"]	8.4kg
P36E33M-WH1B	VERTICAL,(30) C13,(6) C19,MONITORED SWITCHED,200-240V/30A/1 PHASE , TOP-END FED, 2 METER INPUT CORD, WHITE	WHITE (RAL 9003)	2M(+178MM-89MM) 6.5'[+7"/-3.5"]	8.8kg
P36E33M-WH1C	VERTICAL,(30) C13,(6) C19,MONITORED SWITCHED,200-240V/30A/1 PHASE , TOP-END FED, 3 METER INPUT CORD, WHITE	WHITE (RAL 9003)	3M(+254MM-127MM) 10'[+10"/-5"]	9.2kg
P36E33M-YL1A	VERTICAL,(30) C13,(6) C19,MONITORED SWITCHED,200-240V/30A/1 PHASE , TOP-END FED, 1 METER INPUT CORD, YELLOW	YELLOW (RAL 1023)	1M(+178MM-89MM) 3.3'[+7"/-3.5"]	8.4kg
P36E33M-YL1B	VERTICAL,(30) C13,(6) C19,MONITORED SWITCHED,200-240V/30A/1 PHASE , TOP-END FED, 2 METER INPUT CORD, YELLOW	YELLOW (RAL 1023)	2M(+178MM-89MM) 6.5'[+7"/-3.5"]	8.8kg
P36E33M-YL1C	VERTICAL,(30) C13,(6) C19,MONITORED SWITCHED,200-240V/30A/1 PHASE , TOP-END FED, 3 METER INPUT CORD, YELLOW	YELLOW (RAL 1023)	3M(+254MM-127MM) 10'[+10"/-5"]	9.2kg
P36E33M-BU1A	VERTICAL,(30) C13,(6) C19,MONITORED SWITCHED,200-240V/30A/1 PHASE , TOP-END FED, 1 METER INPUT CORD, BLUE	BLUE (RAL 5005)	1M(+178MM-89MM) 3.3'[+7"/-3.5"]	8.4kg
P36E33M-BU1B	VERTICAL,(30) C13,(6) C19,MONITORED SWITCHED,200-240V/30A/1 PHASE , TOP-END FED, 2 METER INPUT CORD, BLUE	BLUE (RAL 5005)	2M(+178MM-89MM) 6.5'[+7"/-3.5"]	8.8kg
P36E33M-BU1C	VERTICAL,(30) C13,(6) C19,MONITORED SWITCHED,200-240V/30A/1 PHASE , TOP-END FED, 3 METER INPUT CORD, BLUE	BLUE (RAL 5005)	3M(+254MM-127MM) 10'[+10"/-5"]	9.2kg
P36E33M-GN1A	VERTICAL,(30) C13,(6) C19,MONITORED SWITCHED,200-240V/30A/1 PHASE , TOP-END FED, 1 METER INPUT CORD, GREEN	GREEN (RAL 6001)	1M(+178MM-89MM) 3.3'[+7"/-3.5"]	8.4kg
P36E33M-GN1B	VERTICAL,(30) C13,(6) C19,MONITORED SWITCHED,200-240V/30A/1 PHASE , TOP-END FED, 2 METER INPUT CORD, GREEN	GREEN (RAL 6001)	2M(+178MM-89MM) 6.5'[+7"/-3.5"]	8.8kg
P36E33M-GN1C	VERTICAL,(30) C13,(6) C19,MONITORED SWITCHED,200-240V/30A/1 PHASE , TOP-END FED, 3 METER INPUT CORD, GREEN	GREEN (RAL 6001)	3M(+254MM-127MM) 10'[+10"/-5"]	9.2kg
P36E33M-BL2A	VERTICAL,(30) C13,(6) C19,MONITORED SWITCHED,200-240V/30A/1 PHASE , BOTTOM-END FED, 1 METER INPUT CORD, BLACK	BLACK (RAL 9005)	1M(+178MM-89MM) 3.3'[+7"/-3.5"]	8.4kg
P36E33M-BL2B	VERTICAL,(30) C13,(6) C19,MONITORED SWITCHED,200-240V/30A/1 PHASE , BOTTOM-END FED, 2 METER INPUT CORD, BLACK	BLACK (RAL 9005)	2M(+178MM-89MM) 6.5'[+7"/-3.5"]	8.8kg
P36E33M-BL2C	VERTICAL,(30) C13,(6) C19,MONITORED SWITCHED,200-240V/30A/1 PHASE , BOTTOM-END FED, 3 METER INPUT CORD, BLACK	BLACK (RAL 9005)	3M(+254MM-127MM) 10'[+10"/-5"]	9.2kg
P36E33M-RD2A	VERTICAL,(30) C13,(6) C19,MONITORED SWITCHED,200-240V/30A/1 PHASE , BOTTOM-END FED, 1 METER INPUT CORD, RED	RED (RAL 3020)	1M(+178MM-89MM) 3.3'[+7"/-3.5"]	8.4kg
P36E33M-RD2B	VERTICAL,(30) C13,(6) C19,MONITORED SWITCHED,200-240V/30A/1 PHASE , BOTTOM-END FED, 2 METER INPUT CORD, RED	RED (RAL 3020)	2M(+178MM-89MM) 6.5'[+7"/-3.5"]	8.8kg
P36E33M-RD2C	VERTICAL,(30) C13,(6) C19,MONITORED SWITCHED,200-240V/30A/1 PHASE , BOTTOM-END FED, 3 METER INPUT CORD, RED	RED (RAL 3020)	3M(+254MM-127MM) 10'[+10"/-5"]	9.2kg
P36E33M-WH2A	VERTICAL,(30) C13,(6) C19,MONITORED SWITCHED,200-240V/30A/1 PHASE , BOTTOM-END FED, 1 METER INPUT CORD, WHITE	WHITE (RAL 9003)	1M(+178MM-89MM) 3.3'[+7"/-3.5"]	8.4kg
P36E33M-WH2B	VERTICAL,(30) C13,(6) C19,MONITORED SWITCHED,200-240V/30A/1 PHASE , BOTTOM-END FED, 2 METER INPUT CORD, WHITE	WHITE (RAL 9003)	2M(+178MM-89MM) 6.5'[+7"/-3.5"]	8.8kg
P36E33M-WH2C	VERTICAL,(30) C13,(6) C19,MONITORED SWITCHED,200-240V/30A/1 PHASE , BOTTOM-END FED, 3 METER INPUT CORD, WHITE	WHITE (RAL 9003)	3M(+254MM-127MM) 10'[+10"/-5"]	9.2kg
P36E33M-YL2A	VERTICAL,(30) C13,(6) C19,MONITORED SWITCHED,200-240V/30A/1 PHASE , BOTTOM-END FED, 1 METER INPUT CORD, YELLOW	YELLOW (RAL 1023)	1M(+178MM-89MM) 3.3'[+7"/-3.5"]	8.4kg
P36E33M-YL2B	VERTICAL,(30) C13,(6) C19,MONITORED SWITCHED,200-240V/30A/1 PHASE , BOTTOM-END FED, 2 METER INPUT CORD, YELLOW	YELLOW (RAL 1023)	2M(+178MM-89MM) 6.5'[+7"/-3.5"]	8.8kg
P36E33M-YL2C	VERTICAL,(30) C13,(6) C19,MONITORED SWITCHED,200-240V/30A/1 PHASE , BOTTOM-END FED, 3 METER INPUT CORD, YELLOW	YELLOW (RAL 1023)	3M(+254MM-127MM) 10'[+10"/-5"]	9.2kg
P36E33M-BU2A	VERTICAL,(30) C13,(6) C19,MONITORED SWITCHED,200-240V/30A/1 PHASE , BOTTOM-END FED, 1 METER INPUT CORD, BLUE	BLUE (RAL 5005)	1M(+178MM-89MM) 3.3'[+7"/-3.5"]	8.4kg
P36E33M-BU2B	VERTICAL,(30) C13,(6) C19,MONITORED SWITCHED,200-240V/30A/1 PHASE , BOTTOM-END FED, 2 METER INPUT CORD, BLUE	BLUE (RAL 5005)	2M(+178MM-89MM) 6.5'[+7"/-3.5"]	8.8kg
P36E33M-BU2C	VERTICAL,(30) C13,(6) C19,MONITORED SWITCHED,200-240V/30A/1 PHASE , BOTTOM-END FED, 3 METER INPUT CORD, BLUE	BLUE (RAL 5005)	3M(+254MM-127MM) 10'[+10"/-5"]	9.2kg
P36E33M-GN2A	VERTICAL,(30) C13,(6) C19,MONITORED SWITCHED,200-240V/30A/1 PHASE , BOTTOM-END FED, 1 METER INPUT CORD, GREEN	GREEN (RAL 6001)	1M(+178MM-89MM) 3.3'[+7"/-3.5"]	8.4kg
P36E33M-GN2B	VERTICAL,(30) C13,(6) C19,MONITORED SWITCHED,200-240V/30A/1 PHASE , BOTTOM-END FED, 2 METER INPUT CORD, GREEN	GREEN (RAL 6001)	2M(+178MM-89MM) 6.5'[+7"/-3.5"]	8.8kg
P36E33M-GN2C	VERTICAL,(30) C13,(6) C19,MONITORED SWITCHED,200-240V/30A/1 PHASE , BOTTOM-END FED, 3 METER INPUT CORD, GREEN	GREEN (RAL 6001)	3M(+254MM-127MM) 10'[+10"/-5"]	9.2kg

B

B

A

A

WE ASK THAT YOU CHECK FULLY THE DIMENSIONS, NOTES, AND SIGN THE CLIENT SIGNATURE BOX. THE JOB WILL NOT PROGRESS WITHOUT SIGNED APPROVAL. PLEASE DO NOT DELAY IN RETURNING PROOF AS IT WILL AFFECT DELIVERY

SIGN _____
DATE _____
PRINT _____

TITLE
INTELLIGENT SERIES PDU
P36E33M-XYZ
CUSTOMER DRAWING

ITEM REVISION NAME
DATASHEET FILE NAME:

UNLESS OTHERWISE SPECIFIED
DIMENSIONAL TOLERANCE ARE: mm [IN]

Tolerance(mm)
0<L<50 ±0.5
50<L<250 ±1.0
250<L<500 ±1.5
500<L<1000 ±2.5
1000<L<2000 ±4.0

THIRD ANGLE PROJECTION

MATERIAL/COLOR:
N/A

DRAWING NUMBER:
P36E33M_DC

DRAWN BY: WSJ DATE: 10/18/2017 CHK: SEAN SCALE: NONE

SHT 2 OF 2 SCALE: B

REV	DATE	BY	CHK	APR	DESCRIPTION	ECN
02A	06/07/2018	JF.YU	MIM	JAWI	ADDED SHEET 2 WITH CONFIGURABLE PART NUMBER TABLE AND DESCRIPTION UPDATED IDENTIFICATION TO INCLUDE CONFIGURABLE OPTION DE-CODER UPDATED CIRCUIT BREAKER LABELS WITH ROTATED TEXT	P36E33M
01A	10/18/2017	WSJ	MIM	EDM	INITIAL RELEASE	P36E33M

