

THIS COPY IS PROVIDED ON A RESTRICTED BASIS AND IS NOT TO BE USED IN ANY WAY DETRIMENTAL TO THE INTERESTS OF PANDUIT CORP.

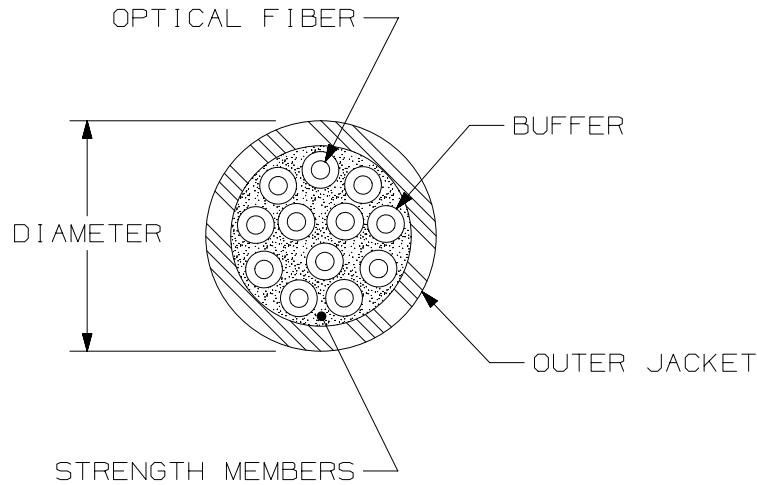

TYPE/DESCRIPTION	COLOR	MAXIMUM LOSS
SINGLEMODE 9/125um 12 FIBER DISTRIBUTION CABLE W/900um TIGHT BUFFER	YELLOW	.75 dB/KM @ 1310nm .75 dB/KM @ 1550nm

PLENUM - FSDP912Y			
TENSILE LOAD		BEND RADIUS	
INSTALLATION	LONG TERM	INSTALLATION	LONG TERM
440 N (100 lbf)	110 N (25 lbf)	124 mm (4.8 in)	62 mm (2.4 in)
CABLE DIAMETER (REFERENCE ONLY)	TEMPERATURE		
	INSTALLATION/OPERATION	STORAGE	
5.8mm DIA [0.23"]	0°C TO +50°C 32°F TO +122°F	-40°C TO +65°C -40°F TO +149°F	

RISER RATED - FSDR912Y			
TENSILE LOAD		BEND RADIUS	
INSTALLATION	LONG TERM	INSTALLATION	LONG TERM
660 N (150 lbf)	165 N (37 lbf)	124 mm (3.8 in)	62 mm (1.9 in)
CABLE DIAMETER (REFERENCE ONLY)	TEMPERATURE		
	INSTALLATION/OPERATION	STORAGE	
6.2mm DIA [0.24"]	-20°C TO +50°C -4°F TO +122°F	-40°C TO +65°C -40°F TO +149°F	

NOTES:

- DIAMETER DIMENSION SHOWN FOR REFERENCE ONLY.
- CABLE SUPPLIED IN 2500 METER (8202 FT) LENGTHS.
- FOR PART NUMBERS AND LENGTHS OTHER THAN THOSE SHOWN, CONTACT YOUR PANDUIT SALES PERSON.
- ALL MATERIALS AND COMPONENTS USED MUST MEET THE MATERIAL RESTRICTIONS OF RoHS, (EUROPEAN DIRECTIVE 2011/65/EU ON THE RESTRICTIONS OF HAZARDOUS SUBSTANCES) AS PROPOSED BY THE RoHS TECHNICAL ADAPTATION COMMITTEE.

WEIGHT OF 2.5km REEL	
OFNP	OFNR
177.7 kg (391.7 lbs)	171.6 kg (378.3 lbs)

PART NUMBER		FSDP912Y, FSDR912Y	
TITLE			
SINGLEMODE 9/125um OPTI-CORE 12 FIBER DISTRIBUTION CABLE W/900um TIGHT BUFFER			
CUSTOMER DRAWING			
ITEM REVISION NAME		M02055BE/01	
DATASET FILE NAME		M02055BE_DC_12-9um/01A	
UNLESS OTHERWISE SPECIFIED, DIMENSIONAL TOLERANCES ARE: IN [mm]		MATERIAL:	
.X ± .XX ±		.XXX ± ANGLES ±	
DRAWING NUMBER:		02055-35	
DRAWN BY		SCALE	
JSP		NONE	
DATE		SHT 1 OF 1	
08-25-04		A	
CHK		SIZE	
WMA		A	

REV	DATE	BY	CHK	APR	DESCRIPTION	ECN
2	9/25/15	JSP	WJM	JGSW	A. UPDATED DRAWING TITLE BLOCK.	02055-35

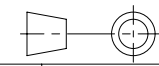

THIRD ANGLE  
PROJECTION

D101000DA/14