



PANDUIT PART NUMBER	WEIGHT
FR12TRBE58 FR12TRBE58M	2.45 LB/EACH (1109g/EACH)



**NOTES:**

- SEE CURRENT CATALOG FOR ADDITIONAL PART SUFFIXES TO INDICATE PACKAGE QUANTITY.
- THE FIBERRUNNER 12x4 QUIKLOCK EXISTING THREADED ROD BRACKET IS USED TO SUPPORT THE FIBERRUNNER 12x4 CABLE ROUTING SYSTEM FROM A SECTION OF EXISTING 5/8" (M16) THREADED ROD.
- THE FIBERRUNNER 12x4 QUIKLOCK EXISTING THREADED ROD BRACKET INCLUDES:  
ONE (1) BRACKET ASSEMBLY,  
TWO (2) 5/8-11 SPLIT LOCK NUTS (FR12TRBE58 ONLY),  
TWO (2) M16x2 SPLIT LOCK NUTS (FR12TRBE58M ONLY),  
ONE (1) 1/4-20 T-BOLT,  
ONE (1) 1/4-20 HEX KEPS NUT
- FINISH COLOR: BLACK (EXCEPT HARDWARE)
- DIMENSIONS IN PARENTHESES ARE IN METRIC.

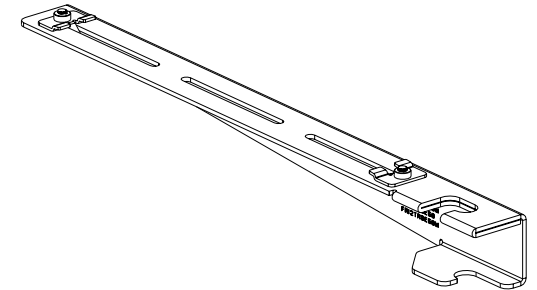
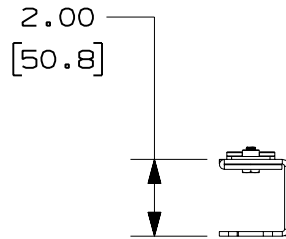
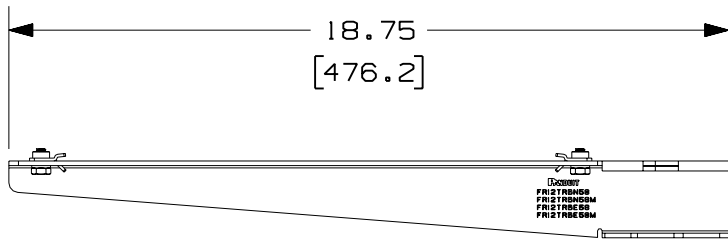
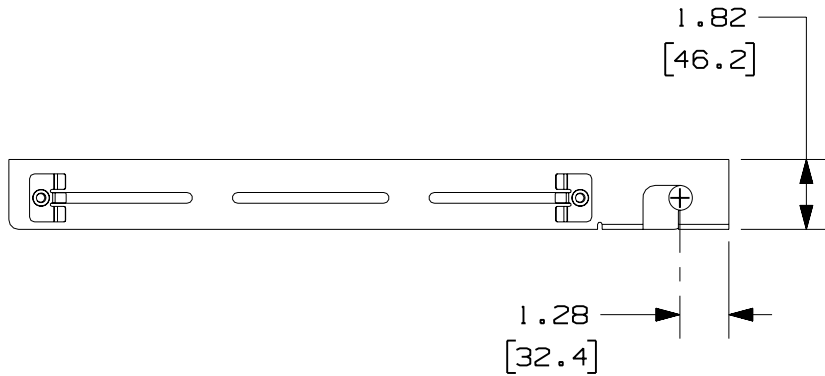

ENG. REF.: D37797CQ\_DC\_FR12TRBE58\_01.prt

CAD FILENAME/LAYERS **FR12TRBE58.pdf**

**PANDUIT** CORP TINLEY PARK, ILLINOIS  
 FIBERRUNNER 12x4 QUIKLOCK EXISTING THREADED ROD BRACKET - 5/8" (M16) THREADED ROD (FR12TRBE58, FR12TRBE58M) CUSTOMER DRAWING

REV	DATE	BY	CHK	DESCRIPTION	ECN	R	CUST	SUP	GMBH
-	-----	---	--	F. REVISED TO INCLUDE FR12TRBE58M.	-----	--	--		
-	-----	---	--	E. REVISED PART WEIGHT.	-----	--	--		
-	-----	---	--	D. REVISED GENERAL NOTES. C. REVISED CAD FILENAME.	-----	--	--		
1	8-2-06	MSO	RN	B. REVISED DRAWING TITLE. A. REVISED AND REDRAWN.	37797-45	RN	RN		

UNLESS OTHERWISE SPECIFIED, DIMENSIONAL TOLERANCES ARE: (.X) ± (.XXX) ± (.XX) ± .03 (.8) ANGLES ±		UNLESS OTHERWISE SPECIFIED, ALL DIMENSIONS ARE GIVEN IN INCHES, THIRD ANGLE PROJECTION.	
DRAWN BY JHNU	MAT'L: STEEL	SCALE NONE	
DATE 5-15-01		DRAWING NO. 37797-45	DWG A SIZE
CHK'D CFG			