

B1



## Low Profile Mounts – Screw Applied

- Low profile design keeps bundle close to mounting surface
- Small overall size
- Install with a screw or rivet for a strong, secure installation
- For indoor use only
- Material: Nylon 6.6

B2

B3

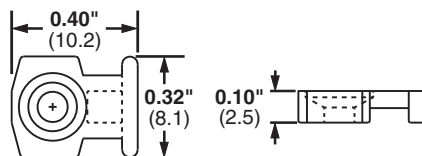

LPMM

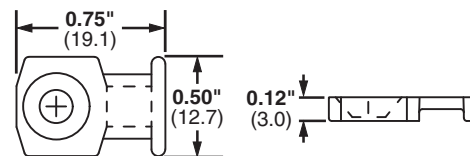

LPMS

C1

C2

C3

Part Number	Used with Cable Ties‡	Color	Mounting Method	Std. Pkg. Qty.	Std. Ctn. Qty.
LPMM-S2-C	M	Natural	#2 (M2) Countersunk Screw	100	1000
LPMM-S5-C			#5 (M3) Countersunk Screw		
LPMS-S8-C	M, I, S	Natural	#8 (M4) Countersunk Screw		

‡Cable tie cross section sizes: M = Miniature, I = Intermediate, and S = Standard.

C4

D1



## Low Profile Mounts – Push Rivet Applied

- Eliminate screws
- Secure wires to any pre-drilled panel
- Can be installed in any panel thickness
- Low profile design keeps bundle close to mounting surface
- For indoor use only
- Material: Nylon 6.6

D2

D3

E1

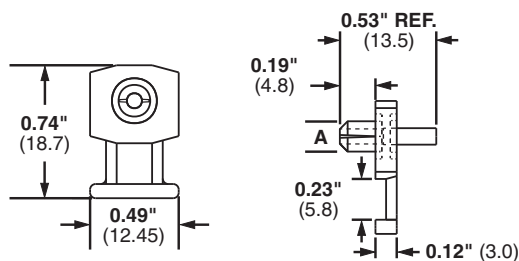

E2

E3

E4

E5

Part Number	Used with Cable Ties‡	Hole Diameter A		Color	Mounting Method	Std. Pkg. Qty.	Std. Ctn. Qty.
		In.	mm				
KIMS-H366-C2	M, I, S	0.144	3.7	Red	Integral Push Rivet	100	1000
KIMS-H430-C6		0.169	4.3	Blue			
KIMS-H500-C4		0.196	5.0	Yellow			

‡Cable tie cross section sizes: M = Miniature, I = Intermediate, and S = Standard.

F

G

H