

# **JBC**

[www.jbctools.com](http://www.jbctools.com)

## **INSTRUCTION MANUAL**



### **RHN**

Rework Hand Support for PHNK

This manual corresponds to the following reference:

**RHN-A**

## Packing List

The following items are included:



**Tool Arm** ..... 1 unit  
Ref. HRR-A



**Height Adj. Flange** ..... 1 unit  
Ref. 0023991



**Shaft** ..... 1 unit



**Base for PHN** ..... 1 unit



**Headless Screw** ..... 1 unit  
Ref. 0017057



**Allen key** ..... 1 unit  
Ref. 0013609



**Manual** ..... 1 unit  
Ref. 0027888

## Features

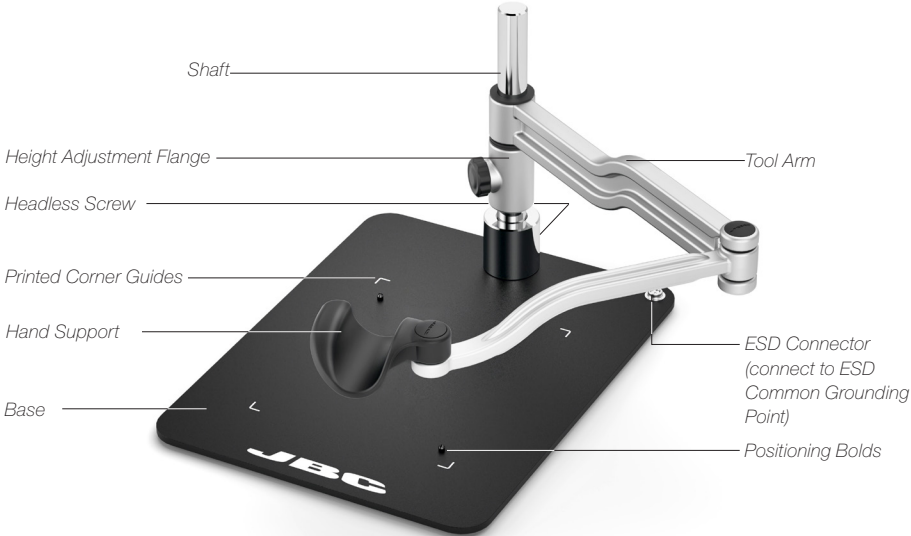

## Assembly

### Setting up the Tool Arm

Fit the shaft into the base bushing (1) and tighten the headless screw. Then assemble first the height adjustment flange (2) and finally the tool arm (3) onto the shaft.

The tool arm position should be like shown in the image. The right hand support is marked at its bottom side with the letter "R".

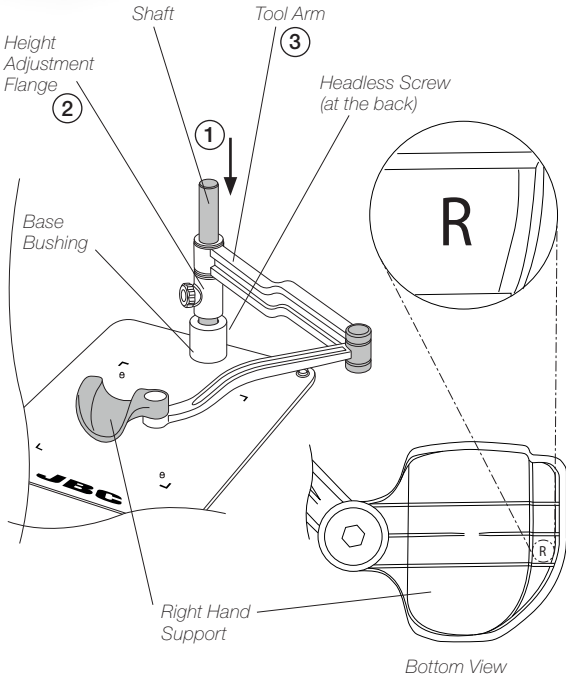

## Height Adjustment

According to your work needs RHN arm allows adjustment for different heights through the vertical axis.

Slide the arm to the appropriate height and secure by tightening the knob to guarantee stability.

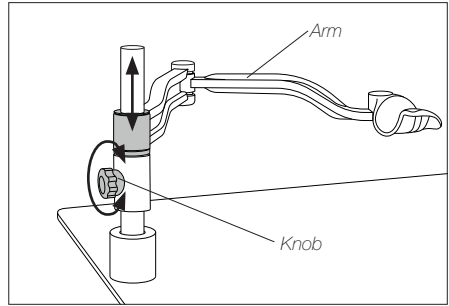

## Work Position Adjustment

RHN arm allows adjustment for different positions according to your work needs. The articulated arm covers all work areas.

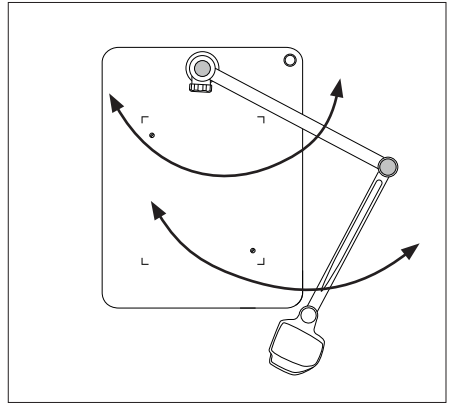
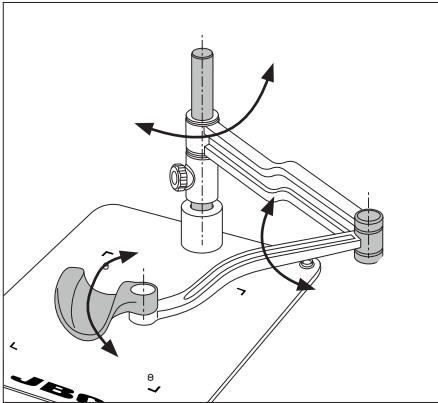

*Position the arm and tighten the knobs.*

The correct hand work position is shown in the following images:

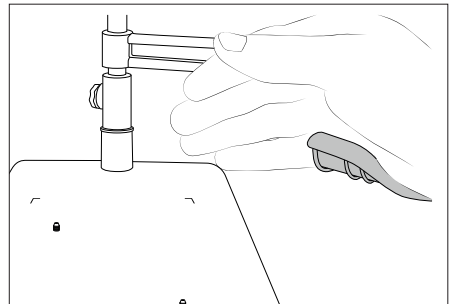
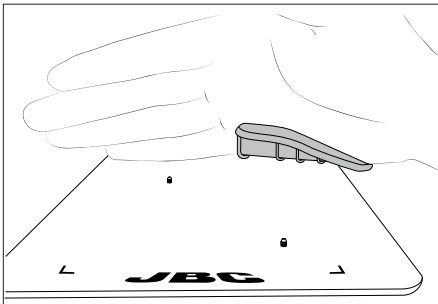

## Preheater Positioning

The position of PHN can be fixed on the base by means of positioning bolts.

Fit the positioning caps onto the positioning bolts (1). The four corner guides (2) helps to the place the heater units in its position.

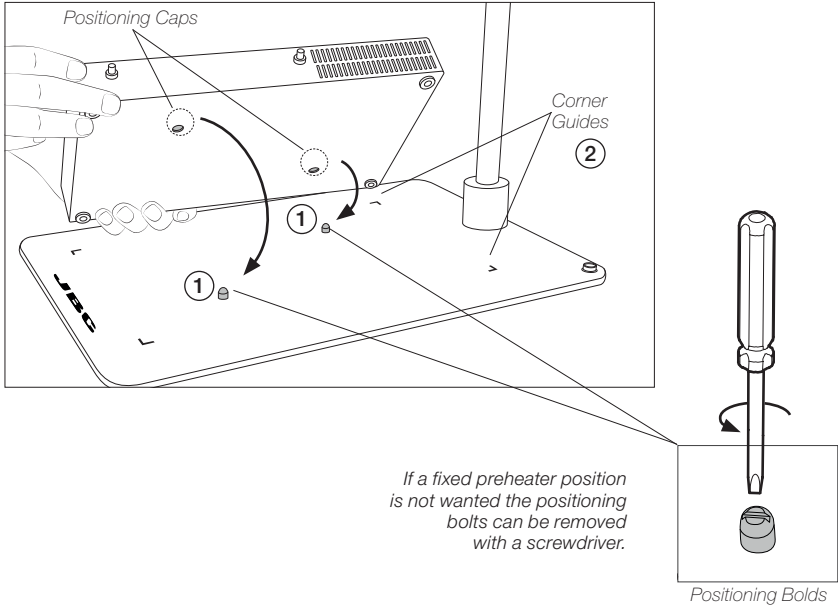

**Note:** For each preheater size there are different rework hand supports with different base dimensions available.

Preheater	Rework Hand Support	Base Dimension
PHNK	RHN	310 x 239 mm / 12.20 x 9.41 in
PHNS	RHS	400 x 270 mm / 15.75 x 10.63 in
PHNB	RHB	550 x 480 mm / 21.65 x 18.90 in

# Accessories\*

If a second hand support is needed choose the Left Hand Support HRL (Ref. HRL-A). HRL allows adjustment for different positions.

**Left Hand Support**  
Ref. HRL-A



In case of using both left and right arms, assemble them as shown in the picture, according with the letter back of the arm support, to keep the supports at the same height.

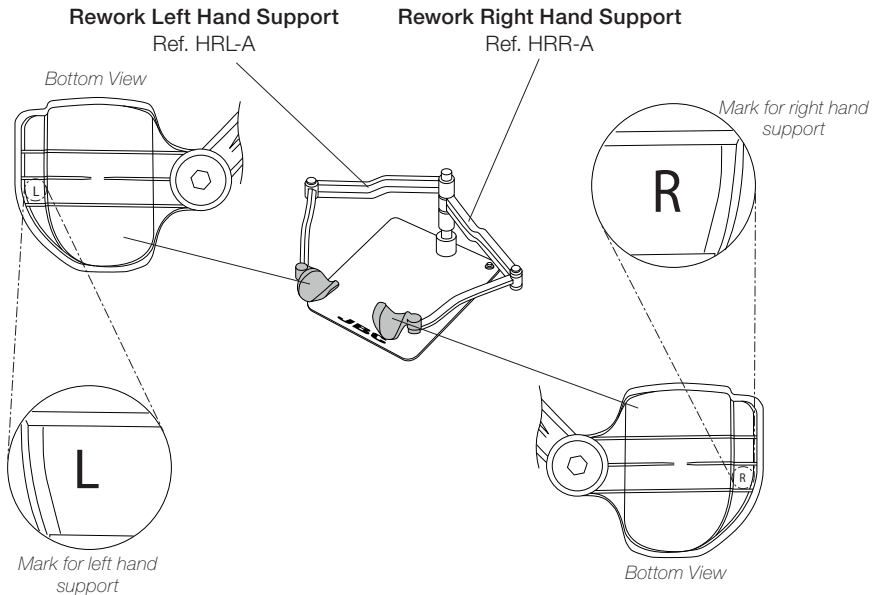

\* Not included, sold separately.

## Accessories\*

The following JBC accessories are ideal additions to the HRL and HRR. They can make hand soldering easier.

Heaters Hose Set Holder is suitable for JTSE and TESE:

- **RWT Rework Adjustable Arm Without Base**  
Ref. RWT-B

4 different sizes for PCB Supports are available:

- **PHNK Nano Preheater Set**  
Ref. PHB-SA
- **PHSK Small Preheater Set**  
Ref. PHB-SA
- **PHBK Large Preheater Set**  
Ref. PHB-SA
- **PHXK XL Preheater Set**  
Ref. PHB-SA

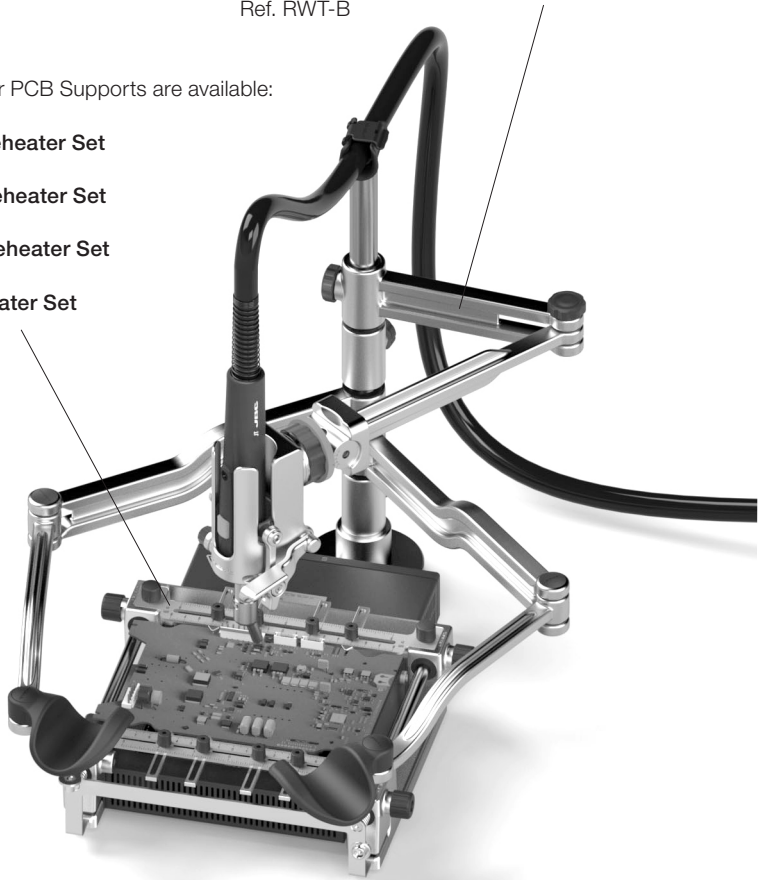

\* Not included, sold separately.

## Maintenance

- Check periodically that RHN is clean, especially the sliding parts and the shaft.
- Use a damp cloth when cleaning. Alcohol can only be used to clean the metal parts.
- Replace any defective damaged parts. Use original JBC spare parts only.

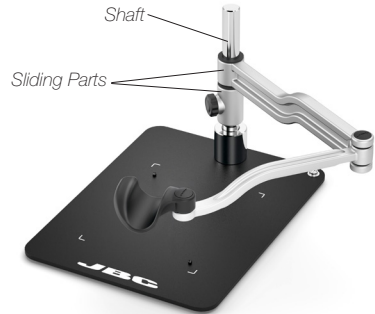
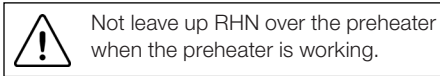

## Safety

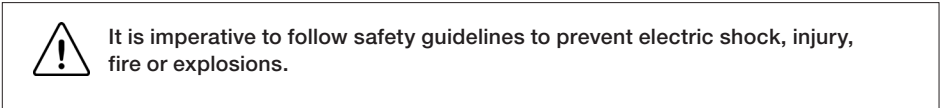

- Do not use the equipment for any purpose other than PCB rework.
- The temperature of accessible surfaces may remain high after the unit is turned off. Handle with care.
- Be careful with the fumes produced when soldering.
- Keep your workplace clean and tidy. Wear appropriate protection glasses and gloves when working to avoid personal harm.
- Not leave up the arms directly above heat surfaces.
- Utmost care must be taken with liquid tin waste which can cause burns.
- This appliance can be used by children over the age of eight as well as persons with reduced physical, sensory or mental capabilities or lacking experience provided that they have been given adequate supervision or instruction concerning use of the appliance and understand the hazards involved. Children must not play with the appliance.
- Maintenance must not be carried out by children unless supervised.



**Notes**

---

---

---

---

---

---

---

---

---

---

---

---

---

---

---

---

---

---

---

---

---

---

---

---

---

---



Notes

---

---

---

---

---

---

---

---

---

---

---

---

---

---

---

---

---

---

---

---

---

---

---

---

# Specifications

## RHN

### Rework Hand Support for PHNK

Ref.: RHN-A

- Base Dimensions: 310 x 239 mm / 12.20 x 9.41 in
- Total Height: 205 mm / 8.07 in
- Arm Height: 200 mm / 7.87 in
- Arm Length: 498 mm / 19.61 in
- ESD Connector
  
- Total Net Weight: 4.50 kg / 9.92 lb
- Package Dimension / Weight: 370 x 204 x 370 mm / 6.09 kg  
(L x W x H) 14.57 x 8.03 x 14.57 in / 13.43 lb

Complies with CE standards  
ESD Safe

# JBC

## Warranty

JBC's 2 year warranty covers this equipment against all manufacturing defects, including the replacement of defective parts and labour.

Warranty does not cover product wear or misuse.

In order for the warranty to be valid, equipment must be returned, postage paid, to the dealer where it was purchased.



This product should not be thrown in the garbage.

In accordance with the European directive 2012/19/EU, electronic equipment at the end of its life must be collected and returned to an authorized recycling facility.



[www.jbctools.com](http://www.jbctools.com)