

# JBC

[www.jbctools.com](http://www.jbctools.com)

## INSTRUCTION MANUAL



### RHS

Rework Hand Support for PHSK

This manual corresponds to the following reference:

**RHS-A**

## Packing List

The following items are included:



**Hand Support Arm** ..... 1 unit  
Ref. HRR-A



**Height Adjustment Flange** .... 1 unit  
Ref. 0023991



**Shaft** ..... 1 unit



**Base PHS compatible** ..... 1 unit



**Headless Screw** ..... 1 unit  
Ref. 0017057



**Allen key** ..... 1 unit  
Ref. 0013609



**Manual** ..... 1 unit  
Ref. 0028766

## Features



## Assembly

### Setting up the Hand Support Arm

Fit the shaft into the base bushing (1) and tighten the headless screw (2). Then assemble first the height adjustment flange (3) and finally the hand support arm (4) onto the shaft.

The hand support arm position should be as shown in the image. The right hand support is marked at its bottom side with the letter "R".

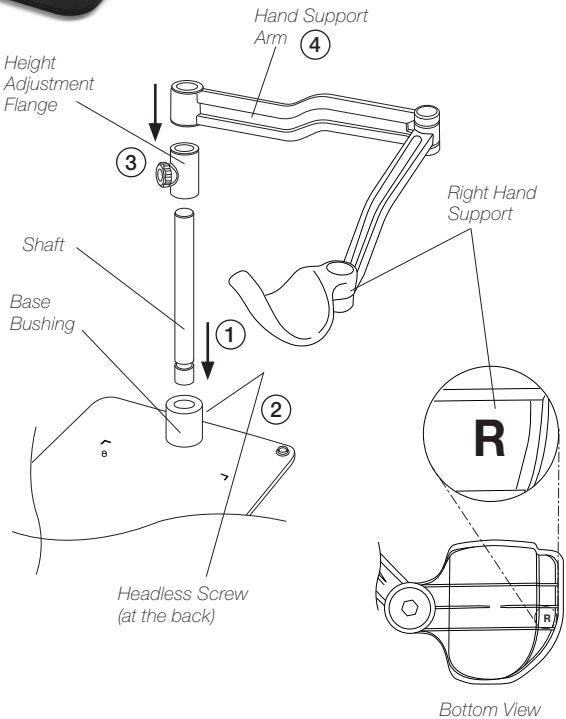

## Height Adjustment

According to your work needs the hand support arm allows adjustment for different heights through the vertical axis.

Slide the arm to the appropriate height (1) and secure by tightening the knob (2) to guarantee stability.

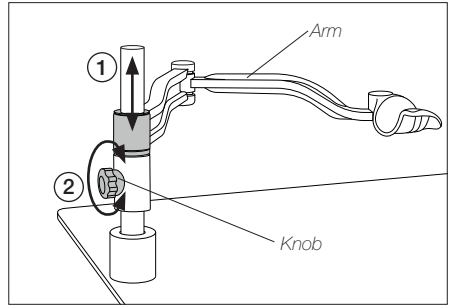

## Work Position Adjustment

RHN arm allows adjustment for different positions according to your work needs. The articulated arm covers all work areas.

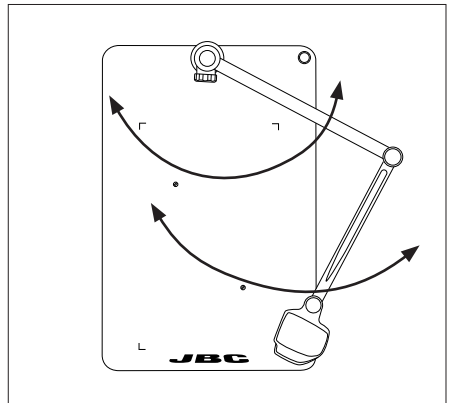
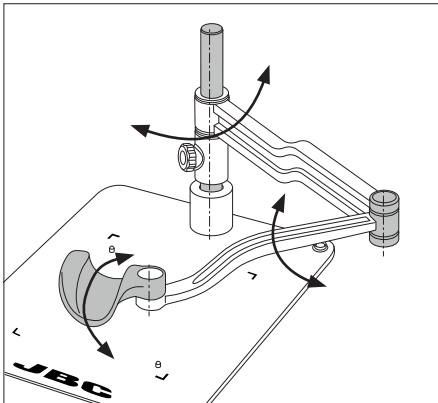

*Position the arm and tighten the knobs.*

The correct hand work position is shown in the following images:

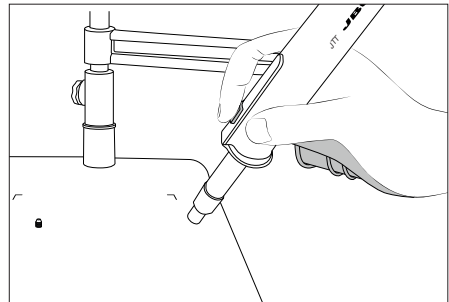
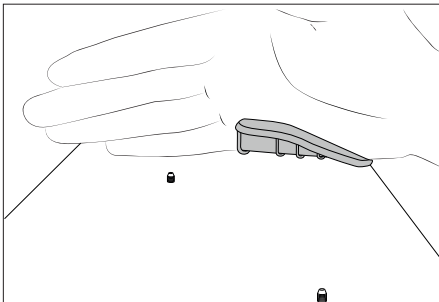

## Preheater Positioning

RHS has been designed to work together with PHS

Fit PHS onto the positioning bolts (1) for a proper alignment. The four corner guides (2) help to place the heater unit in its position.

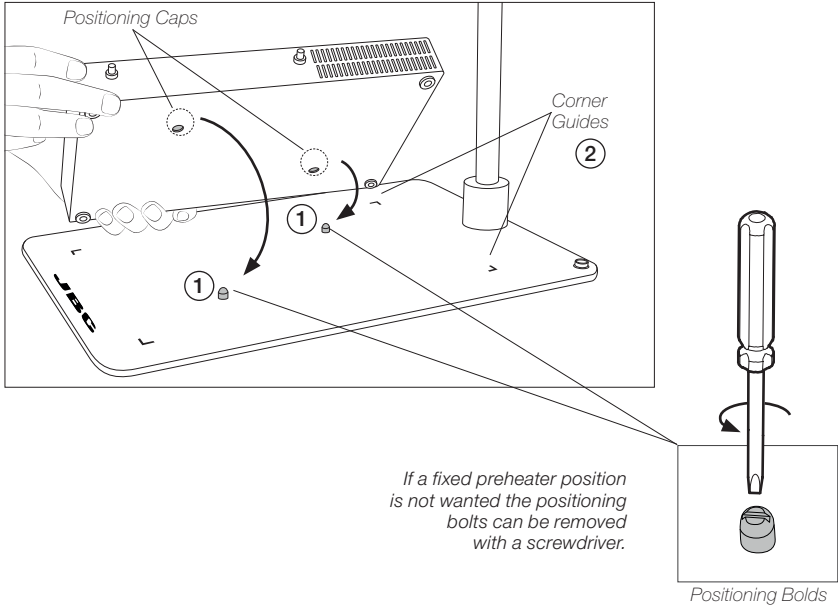

**Note:** For each preheater size there are different rework hand supports with different base dimensions available.

Preheater	Rework Hand Support	Base Dimension
PHNK	RHN	310 x 239 mm / 12.20 x 9.41 in
PHNS	RHS	400 x 270 mm / 15.75 x 10.63 in
PHNB	RHB	550 x 480 mm / 21.65 x 18.90 in

# Accessories\*

If a second hand support is needed, Left Hand Support HRL is available. HRL also allows adjustment for different positions.

**HRL**  
**Left Hand Support**

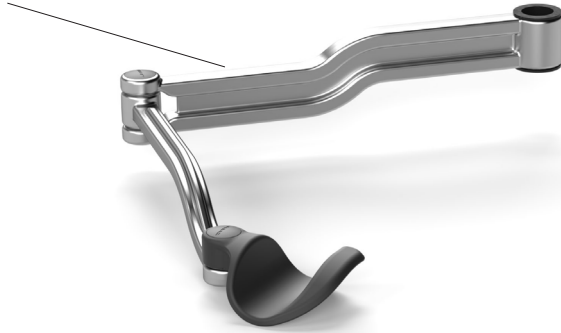

In case of using both left and right arms, assemble both as shown in the illustration according to the letters on the back of the hand support, to keep the hand supports at the same level.

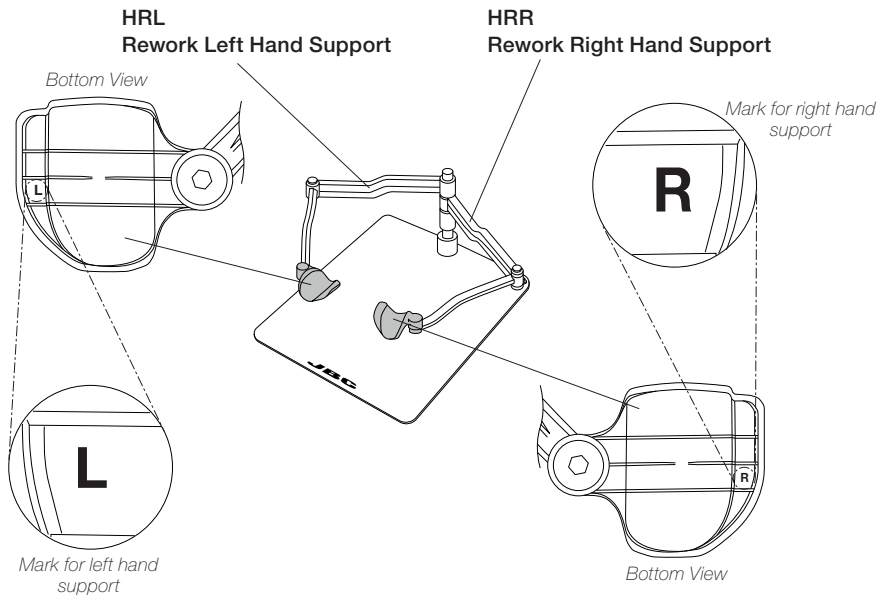

\* Not included, sold separately.

## Compatible JBC Articles\*

HRR and HRL can be combined with RWT, RWS or RWB.

Assemble first the height adjustment flange (1), then the HRR (2) and afterwards the HRL (3). Assemble the second height adjustment flange (4) and finally the RWT (5).

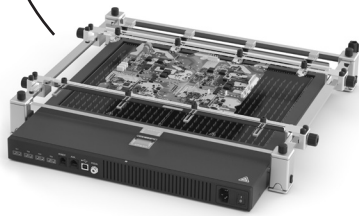
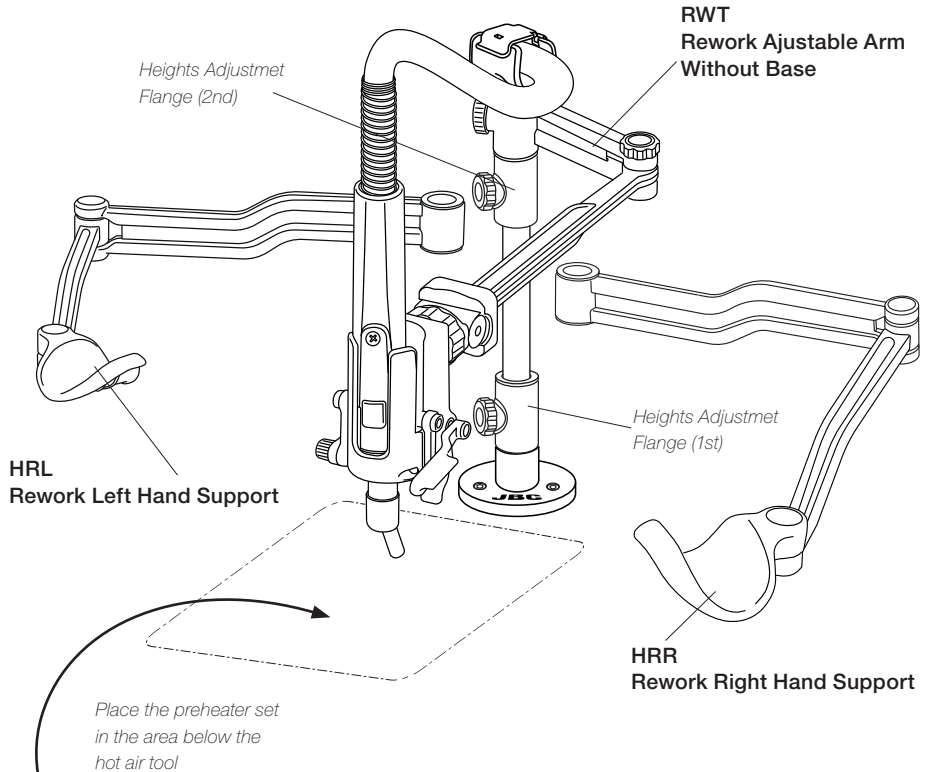

4 different sizes for PCB Supports are available:

- PHNK Nano Preheater Set
- PHSK Small Preheater Set
- PHBK Large Preheater Set
- PHXK XL Preheater Set

\* Not included, sold separately.

## Maintenance

- Check periodically that RHS is clean, especially the sliding parts and the shaft.
- Use a damp cloth when cleaning. Alcohol can only be used to clean the metal parts.
- Replace any defective damaged parts. Use original JBC spare parts only.



 Not leave up RHN over the preheater when the preheater is working.

## Safety

 **It is imperative to follow safety guidelines to prevent electric shock, injury, fire or explosions.**

- Do not use the equipment for any purpose other than PCB rework.
- The temperature of accessible surfaces may remain high after the unit is turned off. Handle with care.
- Be careful with the fumes produced when soldering.
- Keep your workplace clean and tidy. Wear appropriate protection glasses and gloves when working to avoid personal harm.
- Not leave up the arms directly above heat surfaces.
- Utmost care must be taken with liquid tin waste which can cause burns.
- This appliance can be used by children over the age of eight as well as persons with reduced physical, sensory or mental capabilities or lacking experience provided that they have been given adequate supervision or instruction concerning use of the appliance and understand the hazards involved. Children must not play with the appliance.
- Maintenance must not be carried out by children unless supervised.









# Specifications

## RHS

### Rework Hand Support for PHSK

Ref.: **RHS-A**

- Base Dimensions: 270 x 410 mm / 10.6 x 16.2 in
- Total Height: 205 mm / 8.07 in
- Arm Height: 200 mm / 7.87 in
- Arm Length: 498 mm / 19.61 in
- ESD Connector

- Total Net Weight: 6.03 kg / 13.29 lb
- Package Dimension / Weight: 474 x 368 x 195 mm / 7.14 kg  
(L x W x H) 18.66 x 14.49 x 7.68 / 15.73 lb

Complies with CE standards  
ESD Safe

# JBC

## Warranty

JBC's 2 year warranty covers this equipment against all manufacturing defects, including the replacement of defective parts and labour.

Warranty does not cover product wear or misuse.

In order for the warranty to be valid, equipment must be returned, postage paid, to the dealer where it was purchased.



This product should not be thrown in the garbage.

In accordance with the European directive 2012/19/EU, electronic equipment at the end of its life must be collected and returned to an authorized recycling facility.



[www.jbctools.com](http://www.jbctools.com)

0028766-190522