

9465-90 Replacing the Pin

The model 9465-90 pin is a replacement part for the model 9465-10 PIN TYPE LEAD. Perform the following steps to replace the pin.

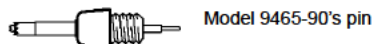

1. Turn off power of the device, and disconnect the pin type lead.
2. Unscrew the cable lock to unlock the cable.
(The cable is locked by screwing the cable lock.)

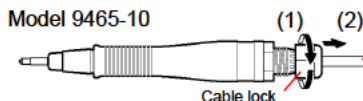

To prevent broken wires;
do not pull the cable, and
do not twist the cable.

3. Hold the pin base so that the cable won't rotate, and then rotate the grip to loosen it.

Beware of injury.
The tip has a
sharp point.

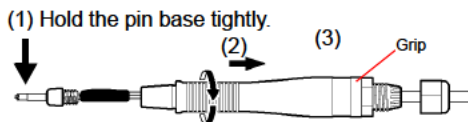

4. Pull off the connector and remove the pin.

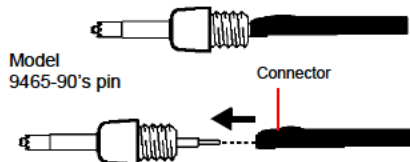

Do not apply a load to the cable to prevent broken wires.

5. Replace the 9465-90 pin tip by inserting a new pin into the socket and pressing against a hard board or other surface to fix the pin firmly in place.



Model
9465-90's pin

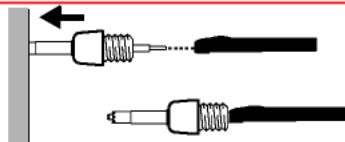

6. Assemble the pin type lead in the reverse order of disassembling.
Do not pull or twist the cable.
7. To avoid broken wires and contact failures, after tightening the cable lock, gently tug and twist the cable to check it is firmly held.
8. Check the performance. Measure an object with a known resistance. Make sure that the measured resistance is correct before using the pin type lead.

Specifications

Operating temperature and humidity	0°C to 40°C (32°F to 104°F), 80%RH or less (no condensation)
Storage temperature and humidity	-10°C to 50°C (14°C to 122°C), 80%RH or less (no condensation)
Operating Environment	Altitude up to 2000 m (6562 feet), Indoors
Size&Weight	Approx. 34 mm (1.34")/ Approx. 1.3 g (0.05 oz.)
Accessories	Instruction manual