

SW2015

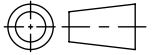

Revision level			Revision Record	Changed	Date	Approved	Date
Drawing	State	Part					
01.1	Design Release		SEE ECN# 013647	GRW	12/9/2016	KAC	12/9/2016

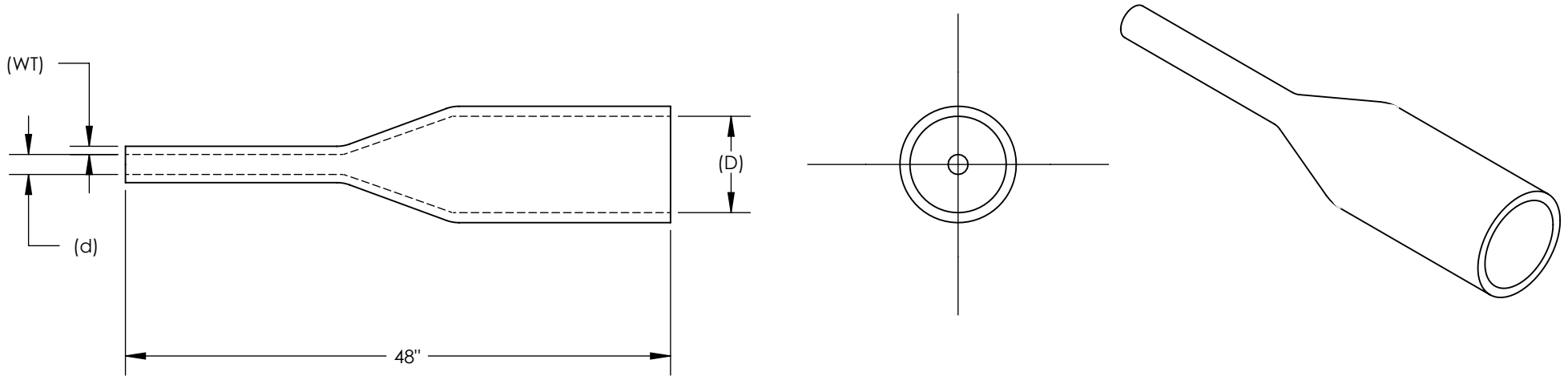

Type	Shrink Ratio	Nominal Trade Size	Supplied Diameter (D)		Recovered Diameter (d)		Wall Thickness Recovered (WT)		Color	Package Quantity
		in	in	mm	in	mm	in	mm		(# of sticks per PACK)
48 Inch Sticks										
TREDUX HA47-48ST-13/4	Up to 3.5:1	1/2	0.512	13.0	0.157	4.0	0.094	2.40	Black	6
TREDUX HA47-48ST-19/6	Up to 3.5:1	3/4	0.748	19.0	0.236	6.0	0.106	2.70	Black	10
TREDUX HA47-48ST-33/8	Up to 3.5:1	1-1/4	1.300	33.0	0.315	8.0	0.126	3.20	Black	5
TREDUX HA47-48ST-45/12	Up to 3.5:1	1-3/4	1.772	45.0	0.472	12.0	0.161	4.10	Black	4
TREDUX HA47-48ST-51/16	Up to 3.5:1	2	2.008	51.0	0.630	16.0	0.161	4.10	Black	2
TREDUX HA47-48ST-68/22	Up to 3.5:1	2-3/4	2.677	68.0	0.866	22.0	0.161	4.10	Black	1
TREDUX HA47-48ST-85/25	Up to 3.5:1	3-1/4	3.346	85.0	0.984	25.0	0.169	4.30	Black	1

- NOTES:**
- SHRINK RATIO 3.5:1
 - LONGITUDINAL CHANGE AFTER SHRINKAGE -10% MAX
 - MINIMUM SHRINK TEMPERATURE 248° F (120° C)
 - OPERATING TEMPERATURES -67° F TO 230° F (-55° C TO 110° C)
 - DIELECTRIC STRENGTH >20KV/MM ACCORDING TO ASTM D 150
 - SOFTENING POINT ADHESIVE 185° F (85° C)
 - ROHS AND HALOGEN-FREE

Material
**POLYOLEFIN,
 ADHESIVE-LINED
 CROSS LINKED**

Units: **inches**
 Dimension without tolerances details to:
 .xxxx = ±.0005
 .xxx = ±.005
 .xx = ±.01
 .x = ±.03
 None = ±.06
 ∠ = ±0.5°
 Dimension Formatted in[mm]

The copyright of this drawing is reserved by HellermannTyton. It is issued on condition that it is not reproduced, copied, or disclosed to a third party, either wholly or in part, without the consent of HellermannTyton.

Drawn GRW 12/9/2016
 Approved KAC 12/9/2016

HellermannTyton
 North America
 Email: corp@htamericas.com
 Web: www.hellermann.tyton.com

Article/Type-No HA47 SERIES
 Title **HEAT SHRINK TUBING, 3.5:1 SHRINK RATIO, ADHESIVE-LINED THICK WALL**
 Drawing-No PRODUCTION : Phase
16-1989-001-CSU

Scale
 Project Number PRP 16-1989
 Format AH
 Sheet 1/1