

NOTES:

1. MATERIALS AND FINISHES:  
 MCX R/A CRIMP PLUG - BeCu, GOLD PLATING  
 CABLE - RG 178
2. ELECTRICAL:  
 A. IMPEDANCE: 50 OHM
3. PACKAGING:  
 A. QUANTITY: SINGLE PACK  
 B. MARKING: BAG TO BE MARKED  
 "AMPHENOL RF, 255104-08-XX.XX AND DATE CODE".

THIRD ANGLE PROJ.

REVISIONS

REV	DESCRIPTION	DATE	ECO	APPR
--	RELEASE TO MFG.	--	--	--
D	FORMAT UPDATED, 18.00", 48.00", METRIC LENGTHS ADDED, & HST LENGTHS ADDED IN LENGTH TABLE	07-Apr-17	3422	VK

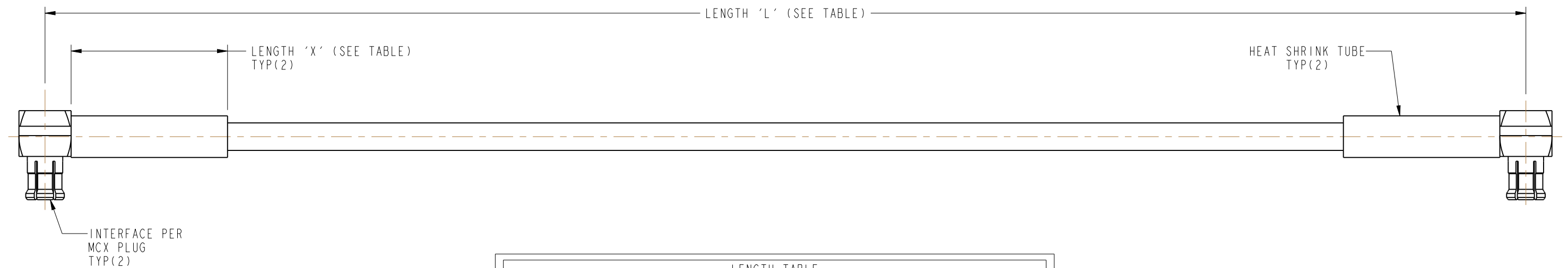
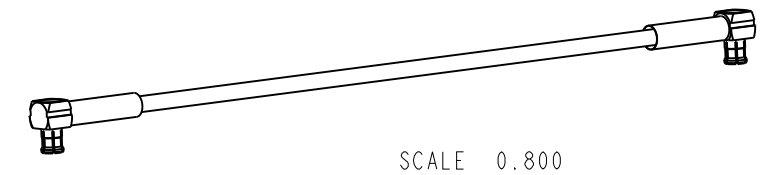

LENGTH TABLE			
PART NUMBER (IMPERIAL)	PART NUMBER (METRIC)	LENGTH 'L' IN INCHES [METERS]	LENGTH 'X' IN INCHES [METERS] MIN
255104-08-06.00	-	6.00 [0.152]	0.75 [0.019]
-	255104-08-M0.25	9.84 [0.250]	
255104-08-12.00	-	12.00 [0.305]	
255104-08-18.00	-	18.00 [0.457]	1.50 [0.038]
-	255104-08-M0.50	19.69 [0.500]	
255104-08-24.00	-	24.00 [0.610]	
-	255104-08-M0.75	29.53 [0.750]	
255104-08-36.00	-	36.00 [0.914]	
-	255104-08-M1.00	39.37 [1.000]	
255104-08-48.00	-	48.00 [1.219]	
-	255104-08-M2.00	78.74 [2.000]	
-	255104-08-M4.00	157.48 [4.000]	

TOLERANCE TABLE	
LENGTH IN INCHES/FT [METERS]	TOLERANCE
0" - 23.90" [0 - 0.607]	±0.25" [0.006]
24.00" - 59.00" [0.610 - 1.499]	±0.50" [0.013]
5.0' - 24.9' [1.524 - 7.617]	±2.5%
25.0' & UP [7.620 & UP]	±5.0%

DESIGN REQUIREMENTS:

- FREQUENCY: \_\_\_\_\_ TO \_\_\_\_\_ GHz       CONTINUITY
- VSWR \_\_\_\_\_ : 1 MAX       HI-POT : 500 VRMS
- INS. LOSS: \_\_\_\_\_ dB MAX       OTHER

**CUSTOMER OUTLINE DRAWING**  
 ALL OTHER SHEETS ARE FOR INTERNAL USE ONLY

UNLESS OTHERWISE SPECIFIED, DIMENSIONS ARE IN INCHES AND TOLERANCES ARE: 2 PLACE DECIMAL      3 PLACE DECIMAL      ANGLES ±.015 (0,381 mm)      ±.005 (0,127 mm)      ± 1°	MATERIAL	DRAWN	DATE	TITLE MCX R/A CRIMP PLUG TO MCX R/A CRIMP PLUG, USING RG 178 CABLE, VARIOUS LENGTH	Amphenol RF www.amphenolrf.com
	SEE NOTES	RAJAGOPAL N	01-Jul-16		
NOTICE - These drawings, specifications, or other data (1) are, and remain the property of Amphenol corp. (2) must be returned upon request; and (3) are confidential and not to be disclosed to any person other than those to whom they are given by Amphenol Corp. the furnishing of these drawings, specifications, or other data by Amphenol Corp., or to any other person to anyone for any purpose is not to be regarded by implication or otherwise in any manner licensing, granting rights to permitting such holder or any other person to manufacture, use or sell any product, process or design, patented or otherwise, that may in any way be related to or disclosed by said drawings, specifications, or other data.	REFERENCE	ENGINEER	DATE	SCALE: 2.6:1.0	SHEET 2 OF 2
	EAR # 7307	CLEMENT	08-Jun-10		
	CONFIGURATION LEVEL: In Work	APPROVED	DATE		
FINISH	K.CAPOZZI	07-Apr-17		DWG SIZE	REV
				B	D
					DRAWING NO. 255104-08-XX-XX
					ITEM NO. 255104-08-XX-XX
					PART NO. 255104-08-XX-XX