

Material:

- Body: Polyamide 6
- Seal: Neoprene
- Flat Seal: Neoprene
- Color: Blue

Technical Properties:

- Maximum strain relief through clamping range
- Trapezoidal thread with high torque guarantees tight and permanent fit of the dome nut
- Gas tight and watertight

Applications:

- Explosion endangered areas
- Machines and devices
- Measuring and control engineering
- Plant installations

Temperature Range

-35 to 95°C
(-31 to 203°F)



L.C.I.E. ATEX

ATEX Characteristics:

Certificate: LCIE 07 ATEX 6082X

Type of protection: Ex e

Test Standards: EN60079-0
EN60079-7

EN61241-0

EN61241-1

Device Group: II

Category: 2 and 3

Atmosphere: G/D

Zone: 1, 2, 21 and 22

NPT Thread

| Outer thread | Clamping range mm | Cat. No. Blue | Std. Pk. |
|--------------|-------------------|---------------|----------|
| NPT 3/8" | 5-8 | 5507760 | 50 |
| NPT 1/2" | 7-12 | 5507761 | 50 |
| NPT 3/4" | 12-18 | 5507762 | 20 |
| NPT 1" | 16-25 | 5507763 | 20 |

Metric Thread*

| Outer thread | Clamping range mm | Cat. No. Blue | Std. Pk. |
|---------------|-------------------|---------------|----------|
| M 12 x 1.5 | 4-6.5 | 5507560 | 50 |
| M 16 x 1.5/9 | 5-8 | 5507561 | 50 |
| M 16 x 1.5/11 | 5-10 | 5507562 | 50 |
| M 20 x 1.5/13 | 7-12 | 5507563 | 50 |
| M 20 x 1.5/16 | 10-14 | 5507564 | 50 |
| M 25 x 1.5/16 | 10-14 | 5507565 | 20 |
| M 25 x 1.5/21 | 12-18 | 5507566 | 20 |
| M 32 x 1.5 | 16-25 | 5507567 | 20 |
| M 40 x 1.5 | 22-32 | 5507568 | 20 |
| M 50 x 1.5 | 28-38.5 | 5507569 | 10 |
| M 63 x 1.5 | 40-48 | 5507570 | 5 |

Dimensions

| Thread Size | H mm | E mm | L mm | ØC mm | ØP mm | ØThread mm |
|-------------|------|------|------|-------|-------|------------|
| NPT 3/8 | 19 | 11 | 38 | 8.5 | 8.7 | 17.1 |
| NPT 1/2 | 24 | 14 | 44 | 12.5 | 12.5 | 21.2 |
| NPT 3/4 | 33 | 15 | 54 | 18.5 | 18.5 | 26.7 |
| NPT 1 | 42 | 18 | 60 | 25.5 | 25.5 | 33.3 |
| M12x1.5 | 15 | 8 | 32 | 6.7 | 6.8 | 12.0 |
| M16x1.5/9 | 19 | 10 | 37 | 8.5 | 8.5 | 16.0 |
| M16x1.5/11 | 22 | 10 | 39 | 10.5 | 10.5 | 16.0 |
| M20x1.5/13 | 24 | 10 | 40 | 12.5 | 12.5 | 20.0 |
| M20x1.5/16 | 27 | 10 | 43 | 14.5 | 14.5 | 20.0 |
| M25x1.5/16 | 27 | 10 | 45 | 14.5 | 14.5 | 25.0 |
| M25x1.5/21 | 33 | 10 | 49 | 18.5 | 18.5 | 25.0 |
| M32x1.5 | 42 | 10 | 52 | 25.5 | 25.5 | 32.0 |
| M40x1.5 | 53 | 10 | 62 | 32.5 | 32.5 | 40.0 |
| M50x1.5 | 60 | 12 | 67 | 39.0 | 39.0 | 50.0 |
| M63x1.5 | 70 | 12 | 68 | 48.5 | 48.5 | 63.0 |

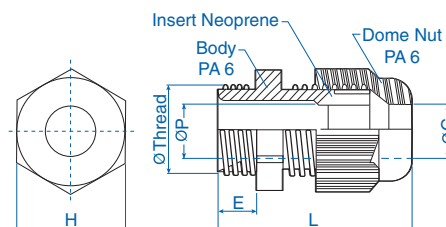

* Extended thread available consult Altech

Locknuts sold separately, see page 24.