

# ISO-TIP

## SOLDERPRO 50 #7971

Butane Soldering Iron  
Portable Model Multi-function Heat Tool

### How To Use SOLDERPRO 50

#### Refueling

- 1.1 Adaptors are not normally required when refilling.
- 1.2 To refill, hold refill can as pictured in diagram 1.2 (fuel transfer is dependent upon gravity).
- 1.3 Observe fuel level in transparent window and stop filling when 90% full.

#### Ignition Sequence-1 SOLDERING IRON

2.1 Push the ON/OFF adjuster upward toward tip to release gas and turn to mid-position. Then holding the unit away from the face and body, activate with the flint igniter or regular lighter.

#### Ignition Sequence-2

2.2 With the other hand, holding it in close proximity to the tip, spin the spark wheel while pointing the stream of sparks at the exhaust ports. The tip will now flame for a few seconds before starting to glow. The flame will then self-extinguish.

#### BLOW TORCH (optional)

2.3 Same as soldering iron but point stream of sparks into the open end of the Blow Torch tip.

#### HEAT BLOWER (optional)

2.4 Same as for soldering iron but point stream of sparks into the open end of the tip. Wait a short time for the flame to self extinguish and to reach operating temperatures.

#### HOT KNIFE (optional)

2.5 Same as for the soldering iron tip.

#### Adjustment

- 3.1 The tip temperature can be adjusted by turning the ON/OFF adjuster.
- 3.2 Normally set the ON/OFF adjuster forward to mid-position when soldering or brazing.
- 3.3 It is not necessary for the catalyst inside the tip to glow bright red to achieve satisfactory soldering temperatures. Experience will dictate the adjuster setting required.

3.4 Excessive gas flow, flare-up, or catalyst pulsing red may occur when the regulator is incorrectly adjusted, i.e., set too high.

#### Changing Tips

4.1 Be sure the tip has cooled before removal. The catalyst seen through the Hot Air Exhaust Hole of the soldering tip is very delicate and will not sustain mechanical abuse without serious damage.

4.2 The soldering tip is easily removable allowing the installation of other style tips or the replacement of a worn tip. After the soldering tip is cool, simply unscrew it with a counterclockwise motion. Be careful not to overtighten as this could damage the nozzle assembly and thread in the body.

#### Built-in Holder

5.1 The built-in holder is designed to hold the soldering iron still to prevent it from rolling off. For continuous use of the soldering tool, we recommend to use a separate metal holder stand, which requires the minimum height of 1-1.5 inches from any flat surface.

#### Troubleshooting

To reduce the risk of personal injury, property damage, or damage to your SOLDERPRO 70, do not attempt to repair the unit body.

Problem	Probable Cause	How to Correct
Does not ignite	a. Empty tank b. Too high or low fuel pressure c. Push ON/OFF Ignition Switch too fast d. Clogged Nozzle Assembly	a. Refill with butane fuel b. Adjust Control Lever to a higher/lower position c. Reread "How To Use Soldering Iron" d. Clean Nozzle Assembly
Low gas pressure or low flame	a. Clogged Nozzle Assembly b. Cold fuel c. Low fuel	a. Clean Nozzle Assembly b. Hold body in hands to allow unit to warm up c. Refuel
Tip does not heat up	a. Worn-out catalyst b. Insufficient fuel pressure c. Clogged Nozzle Assembly	a. Replace with new tip b. Adjust Control Lever to a higher position c. Clean Nozzle Assembly

#### Warranty

Please contact us via phone or e-mail for specific product warranties or any other questions you may have.

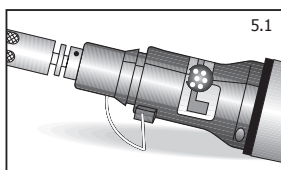
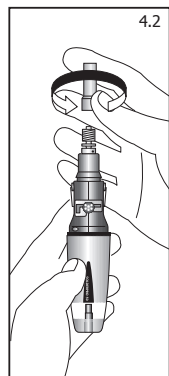
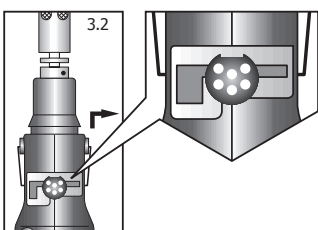
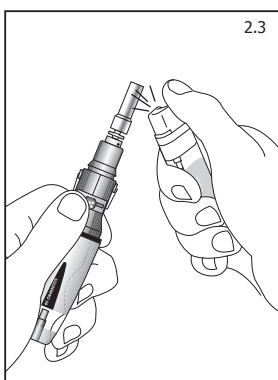
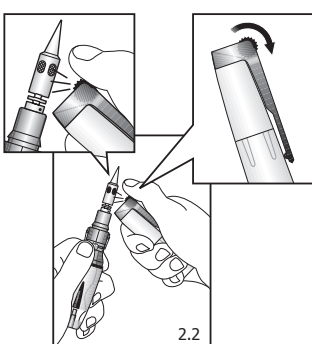
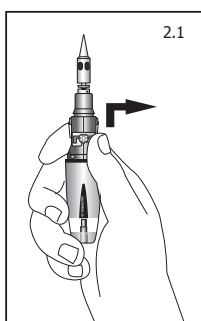
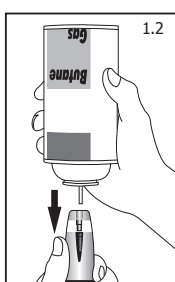

**ISO-TIP**

A Division of Senasys  
www.iso-tip.com  
704 Bartlett Avenue  
Altoona, WI 54720  
(715) 831-6353