

MATERIALS AND FINISHES

BODY BRASS
PLATED GOLD

CENTER CONTACT BERYLLIUM COPPER
PLATED GOLD

INSULATOR TEFLON

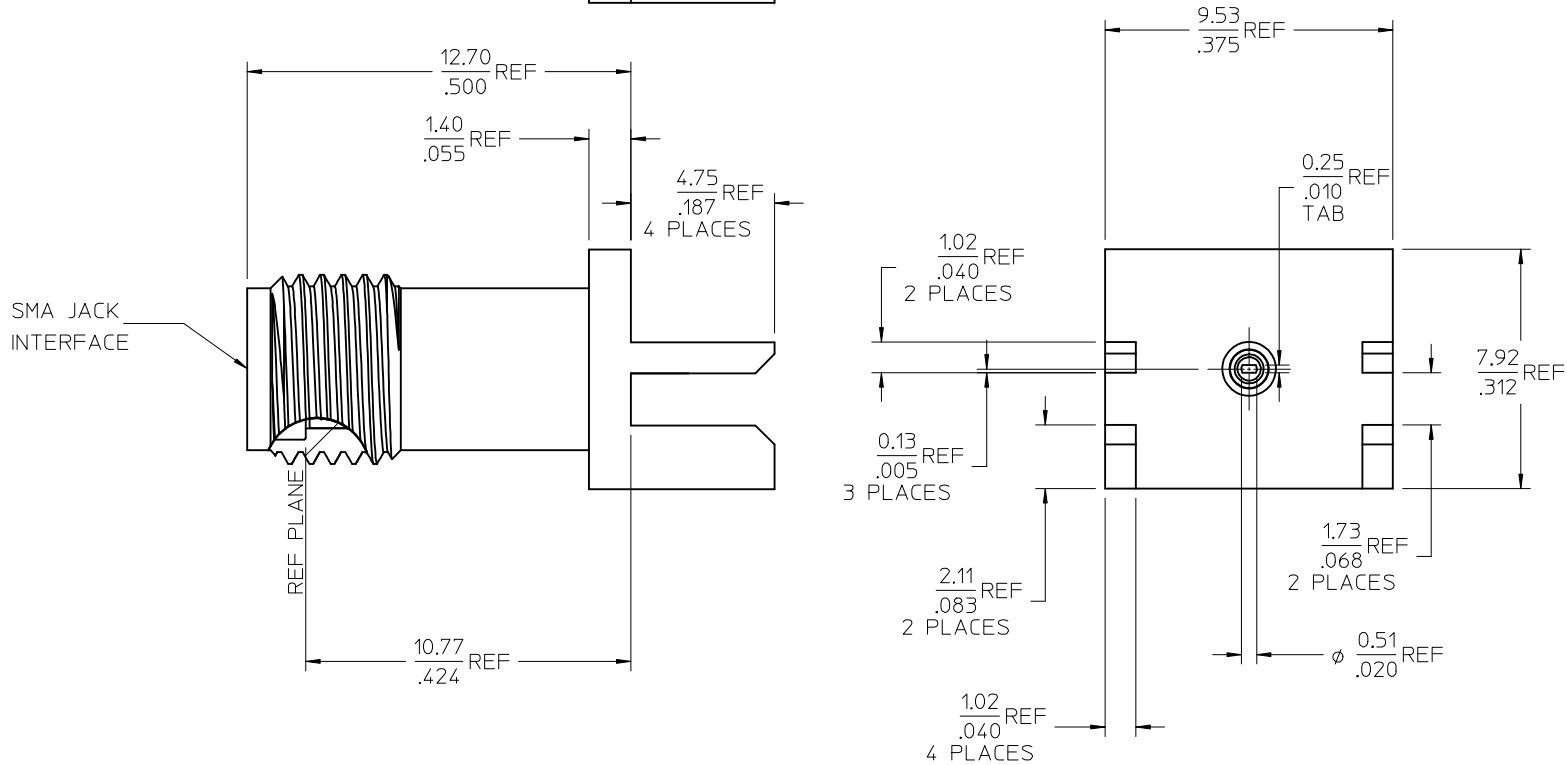
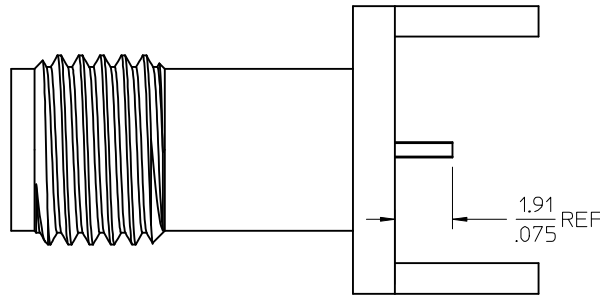
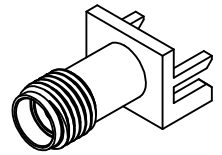

PS-89675-2820	PRODUCT SPECIFICATION
MIL-STD-348A, FIG. 310.2	INTERFACE
SPECIFICATION	DESCRIPTION

73251-0621	73251-0620, ONE PER BAG
73251-0620	BULK
PART NO.	PACKAGING

CHG: REDRAWN TO SHOW REVISED COMPONENTS EC NO: URF2008-0025 DRWN: TELAHERTY 2007/07/13 CHKD: SSHAH 2007/07/13 APPR: JWENER 2007/07/13 A2	QUALITY SYMBOLS ▽=0 ▽=0	GENERAL TOLERANCES (UNLESS SPECIFIED) 4 PLACES ± .005 3 PLACES ± .005 2 PLACES ± .005 1 PLACE ± .005 ANGULAR ± 2°	DIMENSION STYLE MM/IN DRAWN BY: GMH DATE: 1998/10/13 CHECKED BY: _____ DATE: _____ APPROVED BY: _____ DATE: _____	SCALE: _____ DESIGN UNITS: METRIC THIRD ANGLE PROJECTION	TITLE: SMA JACK, EDGE MOUNT 50 OHMS, EWR-3335 SMA-JR MOLEX INCORPORATED
	DRAFT WHERE APPLICABLE MUST REMAIN WITHIN DIMENSIONS	MATERIAL NO. SEE TABLE DOCUMENT NO. SD-73251-062 SHEET NO. 1 OF 1	THIS DRAWING CONTAINS INFORMATION THAT IS PROPRIETARY TO MOLEX INCORPORATED AND SHOULD NOT BE USED WITHOUT WRITTEN PERMISSION		