

Home: [Application Tooling](#) >

**Part Number: 69001-1027**

TM-40/TM-42 Applicator

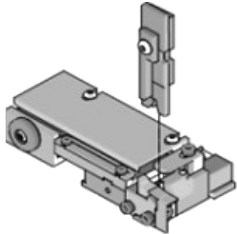

Series image - Reference only

<b>Status:</b>	<b>OBSOLETE</b>
<b>Replacement:</b>	Contact Molex
<b>Series:</b>	<a href="#">69001</a>
<b>Category:</b>	Application Tooling

Go to [Part Detail](#) ▼

[CHECK DISTRIBUTOR INVENTORY](#)

[Add to My Parts](#)

[Email this page](#)

**Product Environmental Compliance**

Questions on Product Environmental Compliance? Email [ProductCompliance@molex.com](mailto:ProductCompliance@molex.com)

Request Molex's CMRT from [conflictminerals@molex.com](mailto:conflictminerals@molex.com)

- [EU ELV](#):Product not active
- [EU RoHS](#):Product not active
- [EU RoHS Phthalates](#):Product not active
- [China RoHS](#):
- [REACH SVHC](#):Product not active
- [Low-Halogen Status](#):Product not active

- [RoHS Certificate of Compliance \(PDF\)](#)
- [Multiple Part Product Compliance Form](#)

**Application Tooling** [FAQ](#)

Tooling specifications and manuals are found by selecting the products below.

Crimp Height Specifications are then contained in the Application Tooling Specification document.

**Description Product #**

**Part Detail**

[VIEW ALL](#)

▶ ▶ [General](#)

▶ ▶ [Reference - Drawing Numbers](#)

**PRODUCTS**

- [Antennas](#)
- [Application Tooling](#)
- [Cable Assemblies](#)
- [Connected Lighting](#)
- [Connectors](#)
- [Copper Flex](#)
- [Electrical Products](#)
- [Industrial Automation](#)
- [Membrane Switches](#)
- [Optical Solutions](#)
- [PCB Assemblies](#)

**QUICK LINKS**

- [Company Information](#)
- [Contact Molex](#)
- [Cross-Reference](#)
- [Koch Industries](#)
- [Industries](#)
- [Literature](#)
- [Molex Racing](#)
- [Press Room / Press Releases](#)
- [Product Index](#)
- [Sitemap](#)

**RESOURCES**

- [Supply Chain Transparency](#)
- [Compliance](#)
- [ecocare](#)
- [Feedback | Help](#)
- [Jobs](#)
- [Legal | Trademarks](#)
- [Mobile Site](#)
- [Supplier Portal](#)
- [Privacy Policy](#)
- [Tradeshows](#)

**STAY CONNECTED**

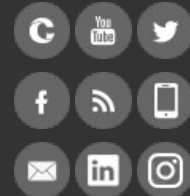

Molex is a registered trademark of Molex, LLC in the United States of America and may be registered in other countries; all other trademarks listed herein belong to their respective owners.

© Copyright 2017