

SQUARE CORNER IS CKT I IDENTIFIER

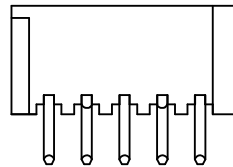

OPTIONAL VOIDED CIRCUIT
SEE CHART FOR LOCATION
SEE NOTE 5

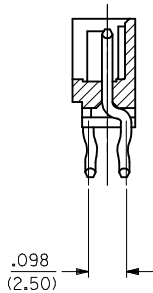
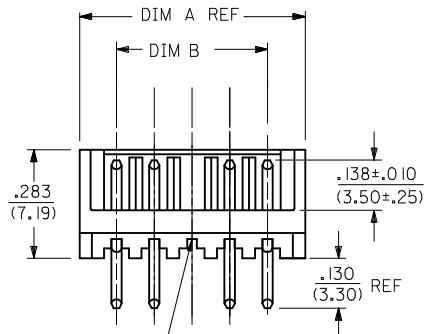
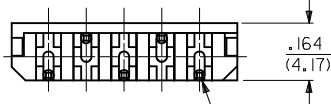

CIRCUIT I

NOTES:

- 1) MATERIAL: HEADER : GLASS-FILLED POLYESTER, UL94V-0, COLOR: WHITE
PIN : BRASS.
- 2) FINISH:
(154) --.000100/(0.00254) MIN. TIN OVER
.000050/(0.00127) MIN. NICKEL UNDERPLATE.
- 3) PRODUCT SPECS: PS-42219-0001.
- 4) PACKAGING SPECIFICATION: PK-42249-0001.
- 5) ANY VOID COMBINATION LEAVING PINS IN ONE ROW ONLY IS NOT AN AVAILABLE OPTION. THE RESULTS WOULD BE MINIMAL BOARD RETENTION.
- 6) THIS PART CONFORMS TO CLASS B REQUIREMENTS OF COSMETIC SPECIFICATION PS-45499-002.

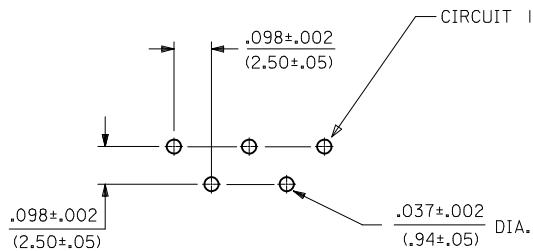

PCB HOLE LAYOUT: COMPONENT SIDE
RECOMMENDED PCB THICKNESS: .062 (1.57)

A-42249-N*-*-*

NO. OF CKTS. PART
COLOR BLANK = STANDARD
A = WHITE SP = SPECIAL
VOID LOCATION

NO. OF CKTS.	KINK LOC.	DIM A IN/(MM)	DIM B IN/(MM)
2	ALL PINS	.292/(7.42)	.098/(2.50)
3	ALL PINS	.391/(9.92)	.197/(5.00)
4	ALL PINS	.489/(12.42)	.295/(7.50)
5	ALL PINS	.587/(14.92)	.394/(10.00)
6	ALL PINS	.685/(17.40)	.492/(12.50)
7	ALL PINS	.783/(19.90)	.591/(15.00)
8	ALL PINS	.882/(22.40)	.689/(17.50)
9	ALL PINS	.980/(24.90)	.787/(20.00)
10	ALL PINS	1.079/(27.40)	.886/(22.50)
11	ALL PINS	1.177/(29.90)	.984/(25.00)
12	ALL PINS	1.276/(32.40)	1.083/(27.50)
13	ALL PINS	1.374/(34.90)	1.181/(30.00)
14	ALL PINS	1.472/(37.40)	1.280/(32.50)
15	ALL PINS	1.571/(39.90)	1.378/(35.00)

REMOVE COLOR OPT. EC NO: UCP2014-2718 DRW:MKIPPER 2014/01/06 CHKD:JBELL 2014/01/07 APPR:FSMITH 2014/01/13	QUALITY SYMBOLS	GENERAL TOLERANCES (UNLESS SPECIFIED)	DIMENSION STYLE IN/MM	SCALE 4:1	DESIGN UNITS METRIC	THIRD ANGLE PROJECTION
	▽=0	4 PLACES ± --- ± ---	DRAWN BY DATE RE 12/17/88	TITLE 2.5 MM HEADER ASSEMBLY (STAGGERED PINS)		
	▽=0	3 PLACES ± --- ±.010	CHECKED BY DATE WRL 12/17/88			
	▽=0	2 PLACES ± 0.25 ±.015	APPROVED BY DATE LENZ 12/17/88	molex DOCUMENT NO. SDA-42249-* SHEET NO. 1 OF *		
▽=0	1 PLACE ± 0.38 ± ---	0 PLACE ± ±				
S3 REV	DRAFT WHERE APPLICABLE MUST REMAIN WITHIN DIMENSIONS ANGULAR ±1/2° SIZE C	THIS DRAWING CONTAINS INFORMATION THAT IS PROPRIETARY TO MOLEX INCORPORATED AND SHOULD NOT BE USED WITHOUT WRITTEN PERMISSION				

A-42249-NA-*				A-422649-NA-*							
OPTIONS	HOUSING	42249-N		OPTIONS	HOUSING	42249-N		OPTIONS	HOUSING		
	COLOR	WHITE			COLOR	WHITE			COLOR		
	PIN NO	45613-0001			PIN NO	45613-0001			PIN NO		
	PLATING	154			PLATING	154			PLATING		
Ckt	Material No	Engineering No	Void Ckts	Ckt	Material No	Engineering No	Void Ckts	Ckt	Material No	Engineering No	Void Ckts
2	22-43-6020	A-42249-2A		3	22-43-6032	A-42249-3A-3	3	2			
3	22-43-6030	A-42249-3A		4	22-43-6041	A-42249-4A-2	2	3			
4	22-43-6040	A-42249-4A		4	22-43-6042	A-42249-4A-3	3	4			
5	22-43-6050	A-42249-5A		6	022-43-6065	A-42249-06A-2	2	5			
6	22-43-6060	A-42249-6A		6	022-43-6061	A-42249-06A-5	5	6			
7	22-43-6070	A-42249-7A		6	22-43-6063	A-42249-6A-51	3,5	7			
8	22-43-6080	A-42249-8A		6	22-43-6064	A-42249-6A-52	2,4	8			
9	22-43-6090	A-42249-9A		7	022-43-6072	A-42249-07A-3	3	9			
10	22-43-6100	A-42264910A		7	022-43-6074	A-42249-07A-5	5	10			
11	22-43-6110	A-42249-11A		7	022-43-6073	A-42249-07A-51	2,5	11			
12	22-43-6120	A-42249-12A		7	022-43-6075	A-42249-07A-52	3,6	12			
13	22-43-6130	A-42249-13A						13			
14	22-43-6140	A-42249-14A						14			
15	22-43-6150	A-42249-15A						15			

REV: S3	ECR/ECN INFORMATION EC NO: UCP2014-2718 DATE: 1/15/2014	TITLE: 2.5 MM HEADER ASSEMBLY (STAGGERED PINS)	SHEET No. - 2 -
DOCUMENT NUMBER: SDA-42249-*		CREATED / REVISED BY: MKIPPER	CHECKED BY: JBELL
		APPROVED BY: FSMITH	