

VA175 **SOLDAVAC[®]** Air and Vacuum Pick-Up System

A revolutionary pick and place system that uses direct AIR or VACUUM to pick-up and place parts and components. Using shop air, the VA175 uses AIR or generates VACUUM for whatever application is necessary. Use as a blower for cleaning and cooling hot components or with the flip of a switch, use the suction to pick-up even the smallest of parts.



Instructional Manual

Warning: High pressure. Do not point tool at anyone.
Do not block any passages along the air lines.

AIR AND VACUUM SETTINGS



Main on off switch



At AIR setting air is blown out the pick-up tool. Air Input 25-45 PSI

At VAC setting air is drawn into the pick-up tool.

Follow these techniques for pick & place

Air Application:
Silicone disk is folded up or is removed. To lift and cool down the component immediately after the leads are desoldered from the pads.*

Pick-up disk must be fitted snug to prevent it from being blown off.



Vacuum Application:
Silicone disk is lowered. To lift and place a component in conjunction with hot air soldering.

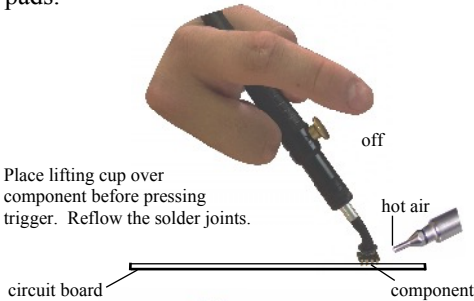

Place lifting cup over component before pressing trigger. Reflow the solder joints.

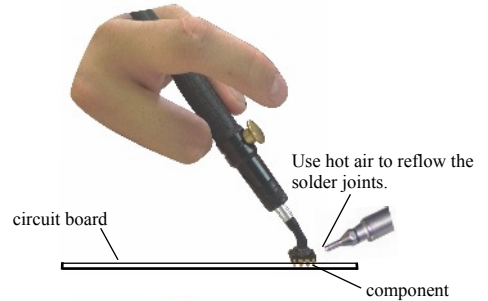

After the solder is molten press trigger to lift component off the circuit board.

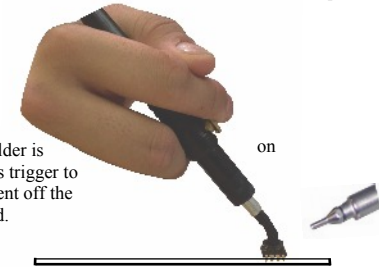

Component is air lifted and cooled at the same time.

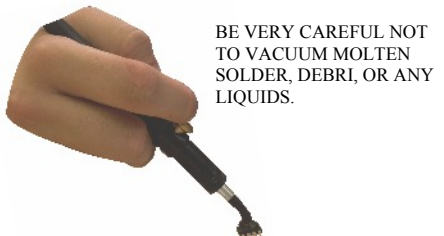

BE VERY CAREFUL NOT TO VACUUM MOLTEN SOLDER, DEBRI, OR ANY LIQUIDS.

*Can also be used for component placement

LP255

SPARE PARTS LIST

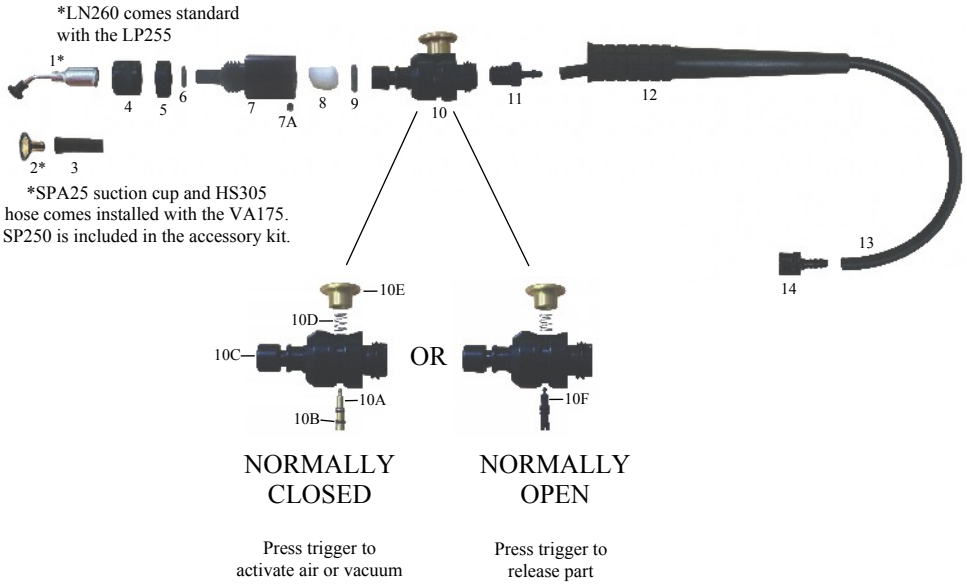

LP255 PICK-UP TOOL

ITEM NO.	PART NO.	DESCRIPTION	QTY NEEDED
1*	LN260	Angled Lifting Needle (includes SP250 suction cup)	1
2*	SPA25	OCTAVAC Air suction pick-up disk with .25" hex brass lifter and .38" static-safe silicone disk	1
3	HS305	Static-Safe Silicone Black Hose ID: 3/32in. x 1/25in.	.052ft.
4	RCA27	Jacking Collar	1
5	SR1109	Gap Sleeve (for appearance only)	1
6	SR894	O-ring	1
7	SR1108	Pick-Up Valve Adapter	1
7A	SR398	Set screw	1
8	AF631	Felt Filter (set of 10)	0.1
9	SR202	O-Ring	1
10	SR700	Trigger Valve Assembly (normally close poppet is standard)	1
10A	SR743	Normally Closed Poppet with O-Rings (gold)	1
10B	SR825	O-Ring	1
10C	SR744	Valve Body	1
10D	SR746	Spring	1
10E	SR745	Push Knob	1
10F	SR742	Normally Open Poppet with O-Rings (blue)	1
11	SR261	Barbed Male Fitting	1
12	SR701	Static-Safe Handle	1
13	HS305	Static-Safe Silicone Black Hose ID: 3/32in. x 1/25in.	3ft.
14	SR402	Female Coupling Quick Disconnect	1

VA175 Exploded View

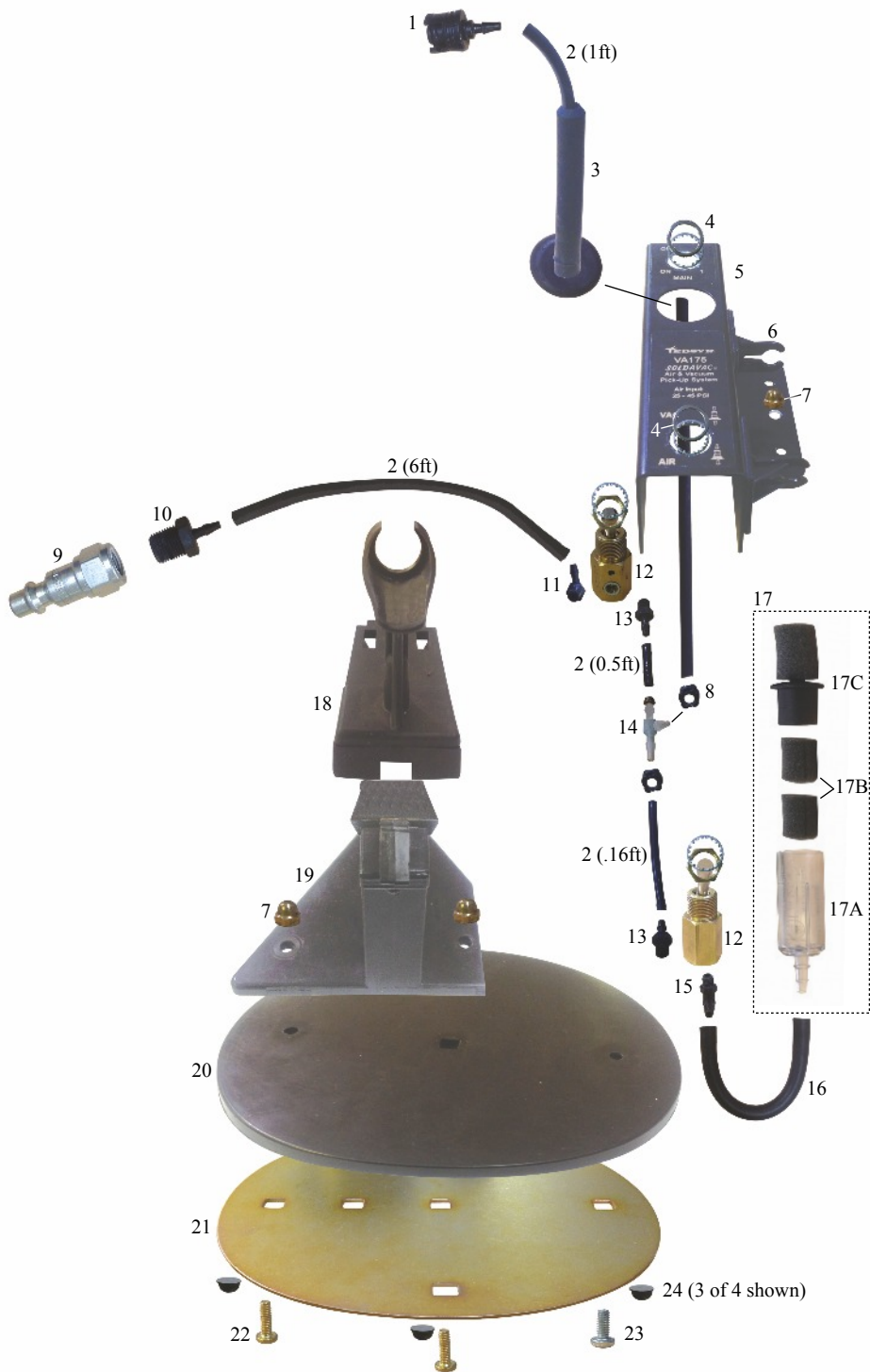

VA175 Spare Parts List

ITEM NO.	PART NO.	DESCRIPTION	QTY NEEDED
1	SR823	Male Coupling Quick Disconnect	1
2	HS308	Polyurethane Black Hose ID: 3/32in. x 1/32in.	7.21ft.
3	SR1107	Strain Relief	1
4	SR785	Nut Ring (Includes star washer)	2
5	SR704	Air /Vacuum Mounting Bracket	1
6	SR439	Holder Clip for Tools and Accessories (Set of 2)	2
7	SR170	Hex Cap Nut	3
8	SR1103	Locking Sleeve	2
9	HB359	Quick Disconnect Fitting	1
10	SR1106	Male Barbed Fitting	1
11	SR1105	Tapped Elbow Fitting	1
12	SR705	2-Way Air Toggle Switch (Includes hex nut and internal star washer)	2
13	SR512	Male Barb Fitting Threded Hose	2
14	SR1104	Venturi Assembly	1
15	SR382	Elbow Connector	1
16	HS307	Static-Safe Silicone Black Hose ID: 1/8in. x 1/16in.	.25ft.
17	AF110S	Air Exhaust Silencer	1
17A	SR533	Clear Barrel	1
17B	AF040	Muffler Filter (Set of 10)	0.2
17C	SR636	Silencer Element Cap	1
18	PD534	Pick-Up Tool Holder	1
19	SR709	Dovetail Bracket Stand	1
20	SR1100	Base Cover	1
21	SR1101	Base Plate	1
22	SR1102	Pan Head Screw	2
23	SR712	Philips Pan Head Screw	1
24	SR251	Rubber Feet (Set of 4)	4

AIR APPLICATION:

The raised corners must sit on component surface. The raised hex corners prevent the component from moving sideways. Care should be taken not to damage hex feet.

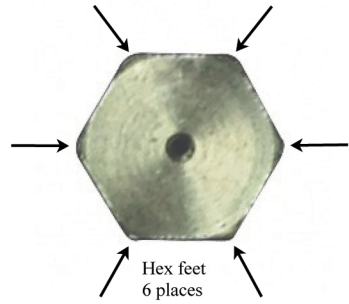

VACUUM APPLICATION:

Many components can still be picked up with or without a suction cup. All accessories shown below are included.

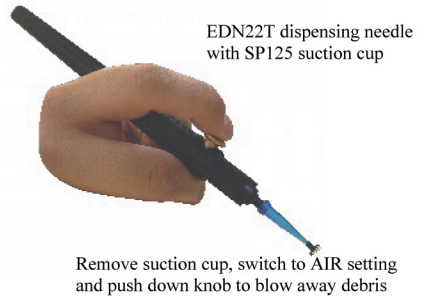

More Included ACCESSORIES

SP093B



Use this suction cup when picking up small components

EDN25T-M



Both the EDN25T and the EDN22T dispensing needles can be used with or without a suction cup

WT623



Use this end to remove listing needle assemblies

Use this end to pry open filter end cap when replacing filter

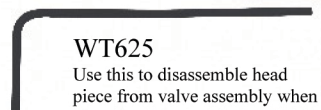

WT625

Use this to disassemble head piece from valve assembly when changing filter inside the LP255

CHANGING POPPET CONFIGURATION (Recommended for Vacuum setting only)

Sometimes the operator would prefer the LP255 to be in the "ON" position all the time (continuous air flow output or vacuum) because more time is actually spent in holding and positioning the component than in releasing it.

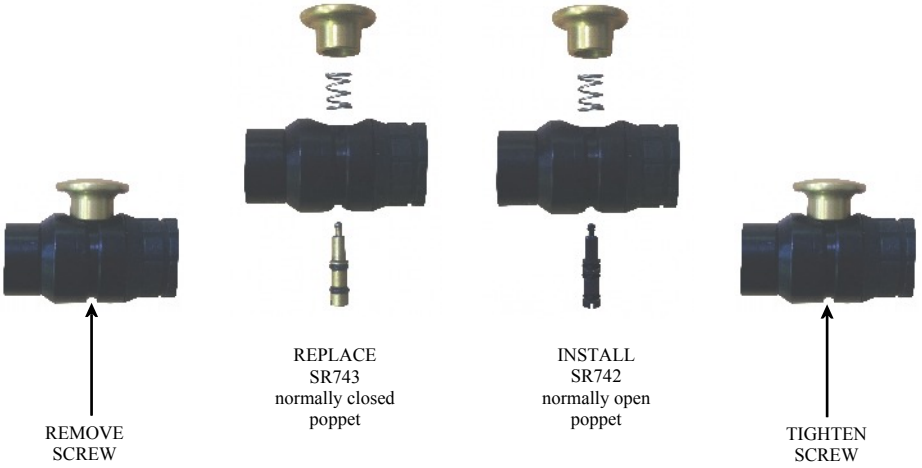







MAINTENANCE

Keep filter elements clean



Suction Cups for the LP255

SPA25	OCTAVAC Air suction pick-up disk with .25" hex brass lifter and .38" static-safe silicone disk	.25" hex	
SPB25	OCTAVAC Air suction pick-up disk with .25" hex brass cup and .38" static-safe silicone disk (for spherical surfaces)	.25" hex	
SPA25-1	Replacement static-safe silicone disk for SPA25 & SPB25	.38" dia.	
SP093B	OCTAVAC static-safe silicone suction cup	3/32" dia.	
SP125	OCTAVAC static-safe silicone suction cup	1/8" dia.	
SP250	OCTAVAC static-safe silicone suction cup	1/4" dia.	
SP375	OCTAVAC static-safe silicone suction cup	3/8" dia.	
SP500	OCTAVAC static-safe silicone suction cup	1/2" dia.	
SP625	OCTAVAC static-safe silicone suction cup	5/8" dia.	
SP750	OCTAVAC static-safe silicone suction cup	3/4" dia.	

More suction cups are available at our website (www.edsyn.com) or in our General Line Catalog.

Warranty

Edsyn stands behind its products. We warrant that new tools will be free from defects for 18 months from the date of purchase. During this time period Edsyn will repair or, at its option, replace the tool at no charge. This warranty does not include tips and accessories. Any tool that appears to have been deliberately abused, altered, or destroyed is not covered by this warranty.

Technical Support

Contact our Customer Service for assistance related to the purchase of this product or recommendations on a challenge that you may encounter. There are many replacement parts that are available to keep your tool in top condition. To speak to someone in Customer Service, call 818-989-2324.

©Copyright 2013 by EDSYN®, Inc. All Rights Reserved

No part of this publication, including individual icons, may be reproduced or utilized in any form or by any means without the written permission of EDSYN®, Inc.



Designed Patented & Assembled in U.S.A. 

Design, color, weight, and material subject to change without notice. Components from other designs may be used with information pertaining to it, but not applicable to another use.
Labels and instructions will supersede this information.



Phone: 818-989-2324 • FAX: 818-997-0895
Email: info@edsyn.com • Internet: www.edsyn.com
Address: 15958 Arminta St, Van Nuys, CA 91406

Form. 956
Rev D