

WORLD'S MOST POWERFUL Mini-Ratchet Drive System

The Only Set You Will Buy in Your Lifetime

PRODUCES 400-INCH LBS. OF TORQUE TO DRIVE AND REMOVE ALL TYPE FASTENERS — INCLUDING SLOTTED SCREWS, INCH AND METRIC HEX SOCKET SCREWS, PHILLIPS, "6 SPLINE" BITS, REED & PRINCE, EVEN 1/4" AND 1/2" SQUARE DRIVE SOCKETS!

Designed for Quick and Easy Assembly Disassembly & Repair Use!

Mini-Ratchets get into smaller and tighter spots and require less effort to yield more torque than any other tool.

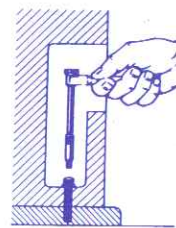

In addition they provide delicate ratchet "feel" and short ratcheting action (only 12° arc) for working on sensitive jobs.

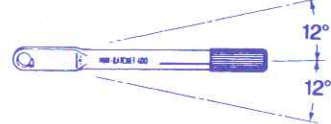

IT'S EASY TO DO EVERY JOB SAFELY AND RIGHT WITH A MINI-RATCHET DRIVE SYSTEM!

With so many options, there's always an easy solution to the problem. All it takes is a moment or two to look it over, decide on which tool to use, try it; then work carefully like a professional.

When snugging up or breaking loose any fastener, apply only a little pressure at a time to "feel" its progress and to make sure it does not break.

Eliminate beat-up screws and broken bits by always using the slotted bit carefully that fits the slot depth, width and length.

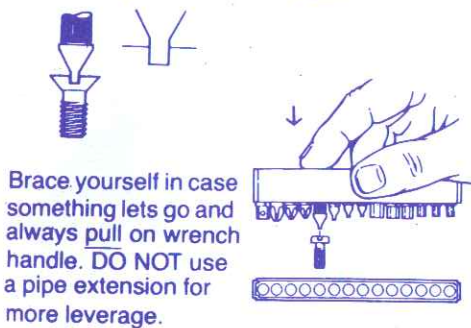

Brace yourself in case something lets go and always pull on wrench handle. DO NOT use a pipe extension for more leverage.

Use bit caddy as shown to test for bit size: To extract bit push down at bottom.

Spin bit knurl to start and remove fasteners. Push down to eject easily.



FOR UNMATCHED VERSATILITY IN ANY MAINTENANCE SITUATION!

Snaps together into any length, handle and tool combination.

Possible component combinations of the Mini-Ratchet drive system.

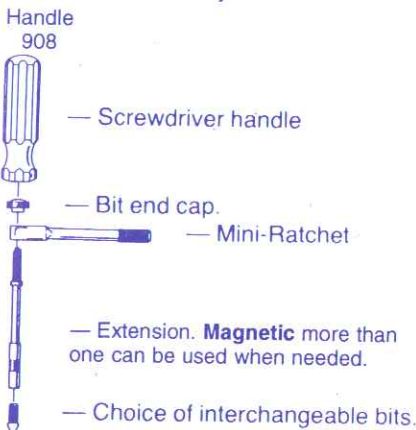

EXTENSION OPERATIONS

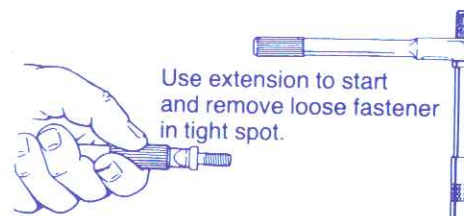

Use extension to start and remove loose fastener in tight spot.

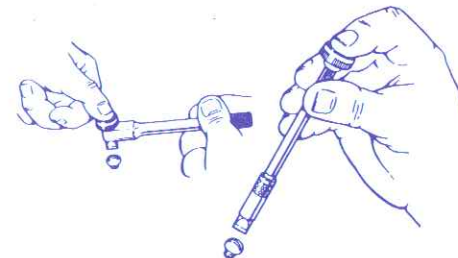

Finger pressure on bit end cap keeps bit in beat-up screw. Finger tip "feel and turn" inserts bit in a blind spot fastener, and quickly starts or removes it. Also shown used on extension and small bits as a jeweler's tool.

SCREWDRIVER HANDLE OPERATIONS

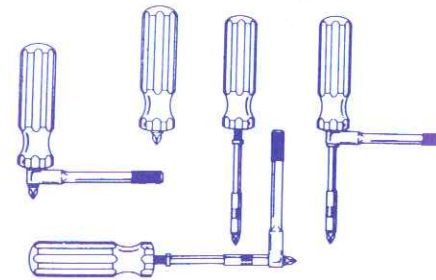

For powerful controlled two-handed action, position Mini-Ratchet between screwdriver handle, bit and extension.

OFFERS CHOICE OF HANDLES FOR HOLDING WEIGHT OF MORE THAN ONE EXTENSION FOR DEEP HOLE USE.

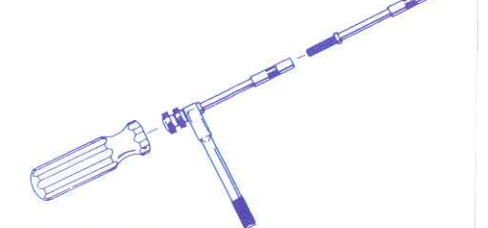

Mini-Ratchet, 1/4" socket adaptor and regular socket. Also, as shown, a 1/4" drive deep hexagon socket allows use of other make hexagon screwdriver bits.

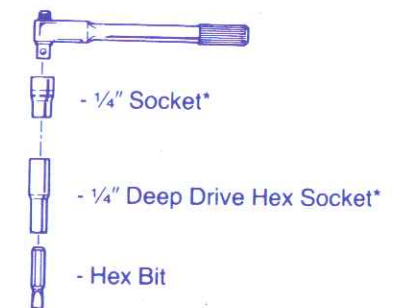

*Not Included

MINI-RATCHET TOOL SETS

Widest Selection of Industrial Quality Tools! Shirt pocket size, rugged polypropylene utility cases with lifetime hinge, self-closing latch, interlocking stacking ribs top and bottom.

SMALL CASE (3/4" x 1 1/2" x 4") 15 Parts

Set No. 10 - 15 Parts
Small molded polypropylene case. Super Mini-Ratchet 400 #72, one 12-Bit Caddy.
9 - Slotted Screw Bits
2 - Phillips
1 - Reed + Prince



MEDIUM SIZE CASE (3/4" x 2 1/4" x 4 3/4") 18 Parts

Set No. 6 - 18 Parts
Medium molded polypropylene case. Super Mini-Ratchet 400 #71, Extension 4 3/16" #70, one 14-Bit Caddy.
6 - Inch Hex Bits
2 - Phillips
5 - Slotted Screw Bits
1 - 1/4" Socket Adaptor



Set No. 5 - 18 Parts

"6 Spline" & Squares: Medium molded polypropylene case. Super Mini-Ratchet 400 #71, Extension 4 3/16" #70, one 14-Bit Caddy.
8 - "6 Spline" Bits
4 - Square Bits
1 - 1/4" Socket Adaptor
1 - Reed + Prince

TWO SETS SELECTION

One Standard Case In Large Case (1 3/8" x 2 1/8" x 4 3/4")



Set No. 1 - 36 Parts

Standard molded polypropylene case. Includes FOUR tools* Three 12-Bit Caddies
9 - Hex Bits
6 - "6 Spline" Bits
5 - Slotted Bits
5 - Metric
2 - Phillips
1 - Reed + Prince

Deluxe Set 3 - 44 Parts

Large molded polypropylene case. Includes FOUR tools* Three Bit Caddies. 36 Bits
12 - Inch Hex Bits
8 - Metric Hex Bits
9 - Slotted Screw Bits
5 - Phillips
1 - Reed + Prince
1 - 1/4" Socket Adaptor

Super Deluxe Set 4 - 52 Parts

Large molded polypropylene case. Includes FOUR tools* Three Bit Caddies. 44 Bits
12 - Inch Hex Bits
8 - Metric Hex Bits
9 - Slotted Screw Bits
5 - Phillips
1 - Reed + Prince
8 - "6 Spline" Bits
1 - 1/4" Socket Adaptor

* FOUR Tools - Ratchet 400L, Extension, Screw Drive, Handle, & End Cap

PRECISION MADE HARDENED ALLOY TOOL STEEL BITS MEET EVERY NEED!

12 - Inch Hex Bits Fit 0 to 3/8 Cap, Etc. Screws.
8 - Metric Hex Fit M3 To M8 Cap Screws.
5 - Phillips Fit Tiny Pocket Calculator To Truck Door Screws.
1 - Reed & Prince (Frearson Fits).
8 - "6 Spline" Bits Auto Parts
9 - Slotted Screw Bits Fit All Type 0-60 to 1/4-20 Screws.
1 - 1/4" Square Drive Adaptor Fits 1/4" Sockets.

All parts are 100% U.S.A. made, torque tested to the Fasteners Institute rigid quality control standards, and are fully guaranteed against faulty workmanship or material.

INCH HEX BITS		METRIC HEX BITS		"6 SPLINE" BITS	
SIZE (in.)	PART NO.	SIZE (MM)	PART NO.	SIZE	PART NO.
.050"	101	1.5MM	315	9	T9
1/16"	102	2 MM	302	10	T10
5/64"	103	2.5MM	325	15	T15
3/32"	104	3 MM	303	20	T20
7/64"	105	4 MM	304	25	T25
1/8"	106	5 MM	305	27	T27
9/64"	107	6 MM	306	30	T30
5/32"	108	8 MM	308	40	T40
3/16"	109				
7/32"	110				
1/4"	111				
5/16"	112				
		SQUARE BITS			
		0	S0		
		1	S1		
		2	S2		
		3	S3		

PHILLIPS HEAD	
SIZE NO.	PART NO.
P0	50
P1	51
P2	52
P3	53
P4	54

SLOTTED SCREW BITS	
SIZE	NO.
0	600
1	601
2	602
3	603
4	604
5	605
8	608
10	610
1/4	625

REED AND PRINCE (FREARSON)	
SIZE NO.	PART NO.
RP	55

1/4" SQUARE DRIVE ADAPTOR	
SIZE NO.	PART NO.
SA	73



EXTENSION (4 9/16" Long)	70
EXTENSION (3 3/4" Short)	69
SCREWDRIVER HANDLE	
908	
SUPER MINI-RATCHET 400 (4 9/16" L)	71
(3 3/4" S)	72

Mini-Ratchet 400s are made of solid, highest quality, polished stainless steel. They have the highest torque strength (over 400 in. lbs), shortest working arc (only 12°), have fewer parts to wear, and can be used in more ways and in tighter spots than any other tool of their kind. Reverse action is obtained by simply turning them over (IN and OUT).

THREE SHIRT-POCKET SIZE, UTILITY CASES FOR ALL SHOP, HOBBY AND HOUSEHOLD USES.

- RUGGED POLYPROPYLENE
- LIFETIME HINGE
- SELF-CLOSING LATCH
- INTERLOCKING STACKING RIBS

	14 BITS CADDY	904
	12 BITS CADDY	905
	K47P	
	K17P	
	K14P	

LIMITED LIFETIME WARRANTY

All Mini-Ratchet Tool Sets are guaranteed to be manufactured free of defective materials or faulty workmanship. Any Mini-Ratchet which fails to give satisfactory service under normal working conditions will be repaired or replaced at no charge. To obtain warranty service, please contact the factory at (860) 346-3644 and obtain a Return Material Authorization number. Return the item(s) to the factory with a copy of original purchase receipt along with the RMA number. All warranty service is FOB, Rockfall, CT.

W.F.M.C. Inc., Rockfall, CT 06481